



CHOUMERT ROAD, PECKHAM RYE, SE15
£200,000 LEASEHOLD

THIS LOVELY ONE-BEDROOM SPLIT-LEVEL FLAT IS SITUATED ON ONE OF PECKHAM RYE'S MOST SOUGHT-AFTER LOCATIONS.

DESCRIPTION:

This lovely one-bedroom split-level flat is situated in one of Peckham Rye's most sought-after locations. The property offers a good-sized living room, a double bedroom, and a large bathroom. The property is situated a stone's throw from Bellenden Road offering many fantastic restaurants, bars, and shops and transport links into Central London via Peckham Rye station with the Overground connections to the tube network. This is a wonderful flat in a superb location and early viewing is highly advised.

Leasehold: 116 years
Service Charge: £2,692/year
Ground Rent: £250/year

Dulwich | 020 8299 2722 | dulwich@winkworth.co.uk

AT A GLANCE

- One Bedroom
- Split Level flat
- Reception Room/Kitchen
- Sought-after Location
- Long Lease
- Chain Free

Winkworth





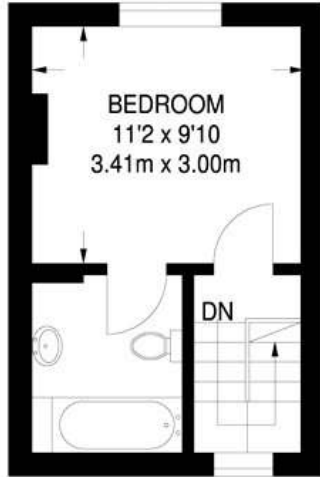

SECOND FLOOR
193 SQ FT / 17.9 SQ M

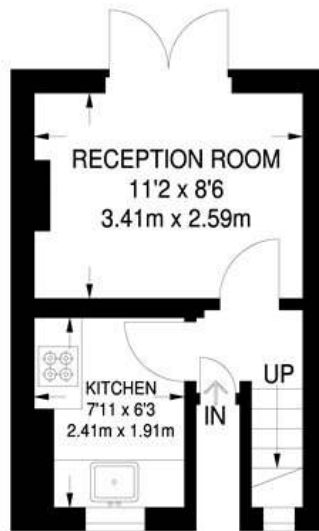

FIRST FLOOR
174 SQ FT / 16.2 SQ M

APPROXIMATE GROSS INTERNAL AREA
367 SQ FT / 34.1 SQ M

This floorplan is for illustration purposes only and is not to scale. The position and size of doors, windows, appliances and other features are approximate.

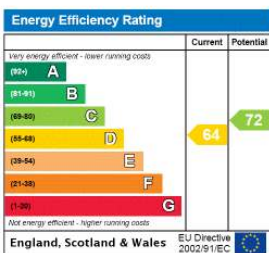

Dulwich | 020 8299 2722 | dulwich@winkworth.co.uk



winkworth.co.uk

See things differently

Winkworth wishes to inform prospective buyers and tenants that these particulars are a guide and act as information only. All our details are given in good faith and believed to be correct at the time of printing but they don't form part of an offer or contract. No Winkworth employee has authority to make or give any representation or warranty in relation to this property. All fixtures and fittings, whether fitted or not are deemed removable by the vendor unless stated otherwise and room sizes are measured between internal wall surfaces, including furnishings.