



ST. THOMAS'S ROAD, LONDON, N4  
£1,670,000 FREEHOLD

A BEAUTIFUL, FIVE BEDROOM, THREE  
BATHROOM FAMILY HOME FINISHED TO THE  
HIGHEST OF STANDARDS IN N4.

Islington | 0207 354 2480 | [islington@winkworth.co.uk](mailto:islington@winkworth.co.uk)

**Winkworth**

[winkworth.co.uk](http://winkworth.co.uk)

See things differently



## DESCRIPTION:

A sensational, five-bedroom, three-bathroom family home positioned on a quiet tree lined street in N4. Standing in excess of 2,100 sqft, the property has been fully renovated by the current owners to an incredibly high standard, maximising all possibilities with optimum family living at the forefront of their mind. Accommodation comprises of a wonderfully bright double reception room, with feature fireplaces and original wood flooring. Leading directly through here, you are welcomed into a stunning kitchen complete with exposed structure, granite worktops and ample dining space creating the perfect entertaining space. The rear south-west facing garden has been meticulously designed with inside-out living through the large, floor to ceiling door and windows, perfect for those summer bbqs. The first floor occupies the family bathroom and offers three excellent sized bedrooms, the master spanning the full width of the house and benefitting from built in storage and an en-suite. A further two bedrooms can be found on the half landing and loft conversion, again having superb storage from the eaves and a cleverly designed en-suite shower room. The property is completed with useful storage from a cellar and further WC.

St Thomas's Road is set in the popular 'Blackstock Triangle' known for its village atmosphere and tree lined streets. The property is located a short distance to a number of leading Islington schools and the

**Winkworth**



**Winkworth**

# St. Thomas' s Road, N4

Approx. Gross Internal Floor Area 2114 sq. ft / 196.38 sq. m (Including Restricted Height Area, Eaves & Cellar)  
 Approx. Gross Internal Floor Area 1875 sq. ft / 174.23 sq. m (Excluding Restricted Height Area, Eaves & Cellar)

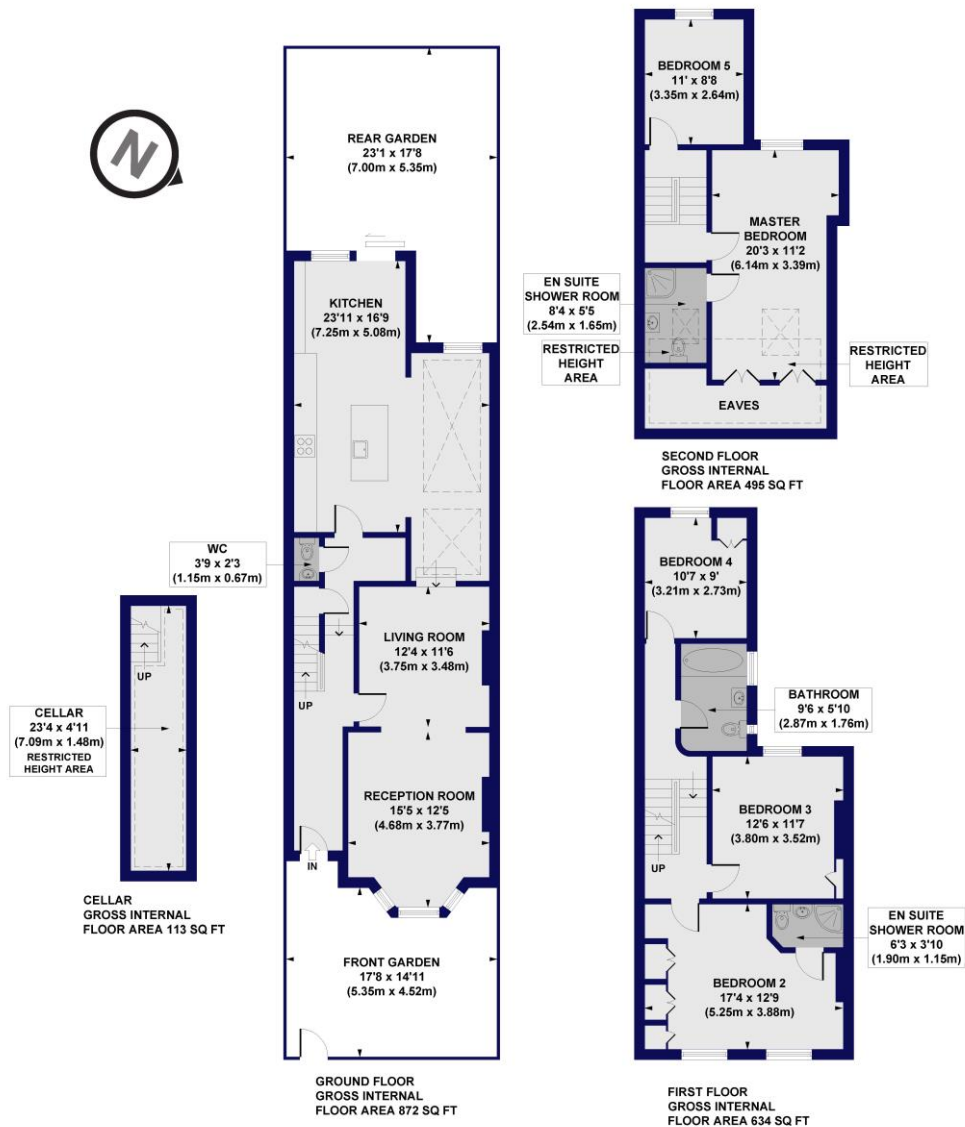

All measurements of walls, doors, windows, fittings and appliances, including their size and location, are shown as standard sizes and do not constitute any warranty or representation by the seller, their agent or CP Creative. Any intending purchaser must satisfy himself by inspection or otherwise as to the correctness of the information contained in these plans. This plan is for illustrative purposes only and should be used as such by any prospective purchasers.



This floorplan is for illustration purposes only and is not to scale. The position and size of doors, windows, appliances and other features are approximate.

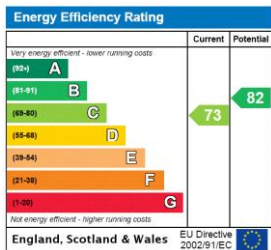

Islington | 0207 354 2480 | islington@winkworth.co.uk



winkworth.co.uk

See things differently

Winkworth wishes to inform prospective buyers and tenants that these particulars are a guide and act as information only. All our details are given in good faith and believed to be correct at the time of printing but they don't form part of an offer or contract. No Winkworth employee has authority to make or give any representation or warranty in relation to this property. All fixtures and fittings, whether fitted or not are deemed removable by the vendor unless stated otherwise and room sizes are measured between internal wall surfaces, including furnishings.