



NORTH END ROAD, LONDON, NW11
£950,000 FREEHOLD

A Contemporary 4 Bedroom, 2 Bathroom House Located close to Golders Hill Park

Golders Green | 020 8458 8313 | goldersgreen@winkworth.co.uk

**4 BEDROOM/ 2 BATHROOM/ KITCHEN/ DINING ROOM/ GARAGE/
OFF STREET PARKING/ SOUTHERLY FACING REAR GARDEN/ CLOSE TO STATION
AND GOLDERS HILL PARK/ EPC: D / COUNCIL TAX BAND:**



DESCRIPTION:

A 4 bedroom, 2 bathroom, semi-detached contemporary house located in this excellent position close to Golders Green station and adjacent to Golders Hill Park.

The house is situated very close to the junction with The Park and virtually opposite King Alfred School. Built on 3 floors, accommodation comprises on the ground floor, a kitchen/breakfast room, a fourth bedroom or study plus integral garage. There is also a guest WC.

On the 1st floor there is a reception room to the rear with a balcony overlooking the garden, plus a master bedroom, dressing room and bathroom. On the 2nd floor there are 2 further bedrooms and a family bathroom. Externally to the rear of the house is a private, secluded southerly facing garden. To the front is a driveway providing off street parking.

Built approximately 30 years ago, the house has a contemporary feel with flexible accommodation, ideal for family living. Best of all is the wonderful location, so close to all amenities, shops, schools, open spaces and transport facilities. Although reasonably maintained, there has been no major changes since the house was originally built and some updating is now required.

The house is being sold chain free with immediate vacant possession being offered.

Viewing is highly recommended.

Tenure: FREEHOLD



North End Road, NW11
 Approx. Gross Internal Floor Area 1457 sq. ft / 135.37 sq. m
 (Excluding Restricted Height Area)

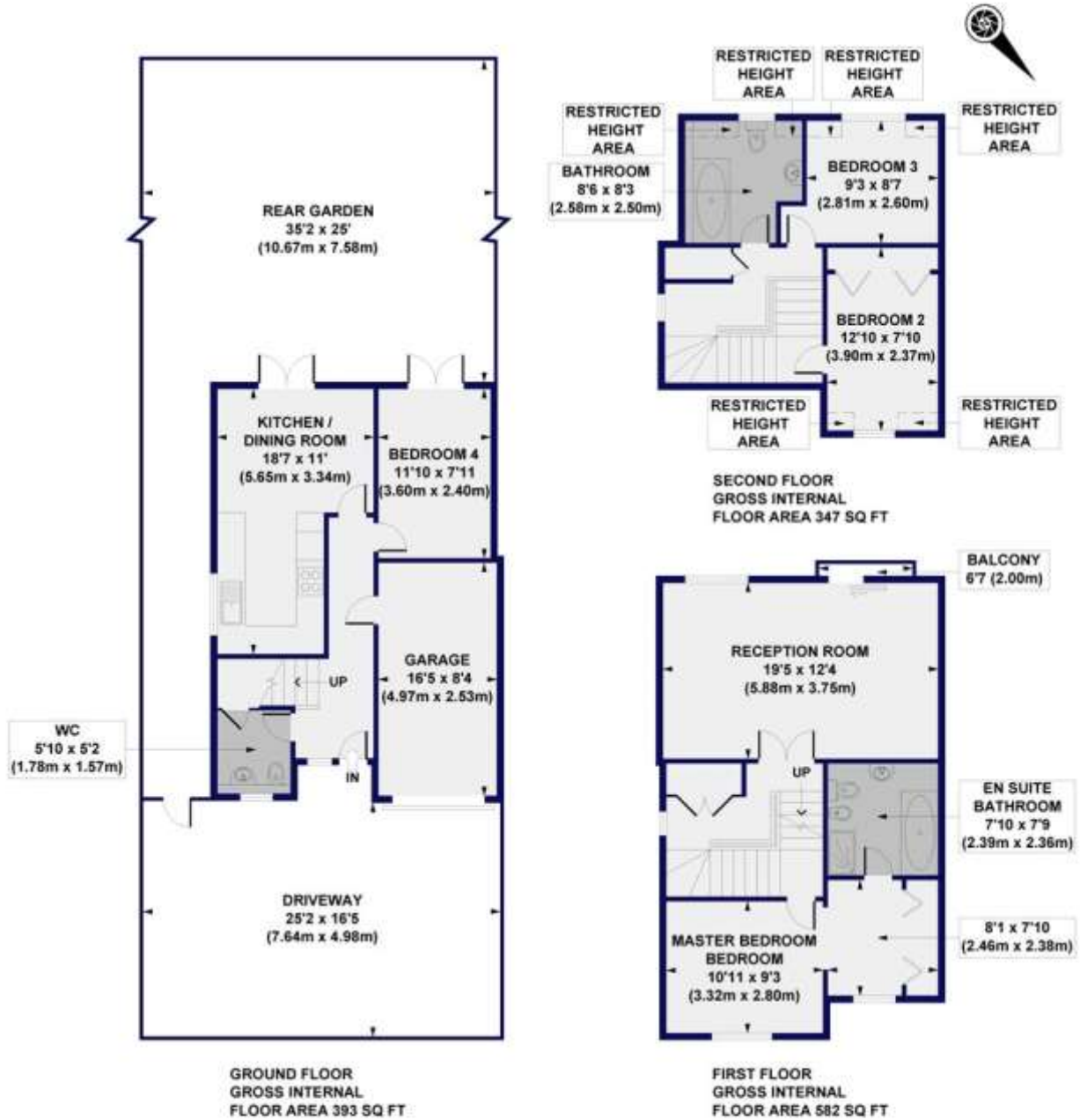

All measurements of walls, doors, windows, fittings and appliances, including their size and location, are shown as standard sizes and do not constitute any warranty or representation by the seller, their agent or CP Creative. Any intending purchaser must satisfy himself by inspection or otherwise as to the correctness of the information contained in these plans.