



ODYSSEY HOUSE, LONDON, SW17
OIEO £350,000 LEASEHOLD

A SPACIOUS ONE BEDROOM MODERN APARTMENT, SET ON THE SECOND FLOOR OF THE ATTRACTIVE ODYSSEY HOUSE

Tooting | 020 8767 5221 | tooting@winkworth.co.uk

Winkworth

for every step...

winkworth.co.uk



DESCRIPTION:

A spacious one bedroom modern apartment, set on the second floor of the attractive Odyssey House. This wonderfully light apartment is flawlessly presented, with a contemporary interior and bright and airy spaces.

There is a stunning south facing reception with incorporated fitted kitchen, benefitting from a range of integrated appliances, whilst an elegant white bathroom suite can be found off the entrance hallway. A sizeable double bedroom with built in wardrobes completes what is an excellent example of a one bedroom apartment.

Odyssey House, situated on Garratt Lane, is perfectly located for access to Tooting Broadway Tube (Northern Line), St George's hospital and a selection of stylish amenities along Tooting high street.



GARRATT LANE, SW17

Approx. Gross Internal Floor Area
506 Sq. ft/46.97 Sq. m

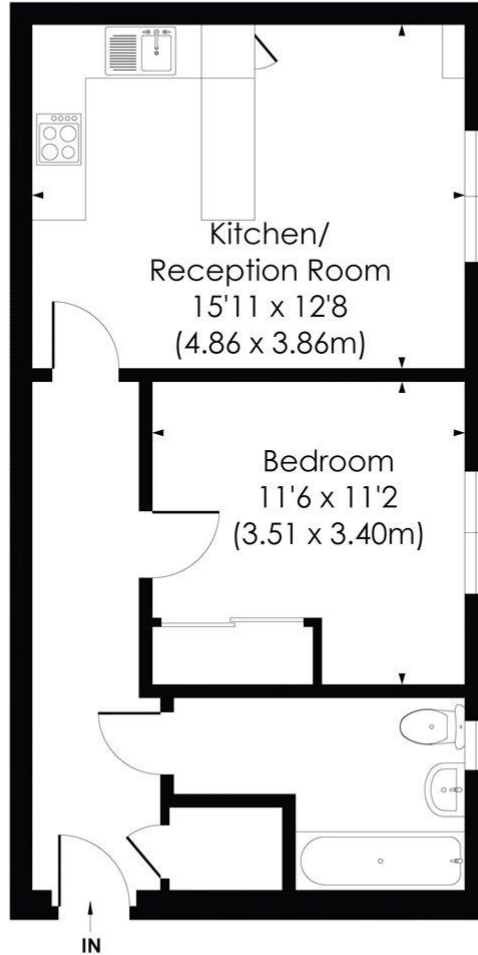

SECOND FLOOR

© Pixangle Property Marketing Ltd. info@pixangle.com Tel: 0208 870 2118

pixangle
 PROPERTY MARKETING

This floor plan has been prepared for the purpose of illustration only in accordance with the latest RICS code of measuring practice and is not to scale. All measurements and areas are approximate and whilst every effort has been made to ensure the accuracy of the plan contained here, no responsibility is taken for any error, omission or misstatement.

This floorplan is for illustration purposes only and is not to scale. The position and size of doors, windows, appliances and other features are approximate.

Energy Efficiency Rating		Current	Potential
Very energy efficient - lower running costs			
(92-100)	A		
(81-91)	B		
(69-80)	C		
(55-68)	D		
(39-54)	E		
(21-38)	F		
(1-20)	G		
Not energy efficient - higher running costs			
England, Scotland & Wales		EU Directive 2002/91/EC	



Tooting | 020 8767 5221 | tooting@winkworth.co.uk

for every step...

winkworth.co.uk

Winkworth wishes to inform prospective buyers and tenants that these particulars are a guide and act as information only. All our details are given in good faith and believed to be correct at the time of printing but they don't form part of an offer or contract. No Winkworth employee has authority to make or give any representation or warranty in relation to this property. All fixtures and fittings, whether fitted or not are deemed removable by the vendor unless stated otherwise and room sizes are measured between internal wall surfaces, including furnishings.