



LONGHURST ROAD, HITHER GREEN, LONDON, SE13 5NA
GUIDE PRICE £800,000-£850,000 FREEHOLD

A STUNNING AND VASTLY IMPROVED, FOUR BEDROOM, TWO BATHROOM, VICTORIAN HOUSE WITH A 37FT SOUTH FACING GARDEN SET IN THIS OUTSTANDING LOCATION CLOSE TO MANOR HOUSE GARDENS AND HITHER GREEN STATION.

Blackheath | 0208 8520999 | blackheath@winkworth.co.uk

Winkworth

winkworth.co.uk

See things differently



DESCRIPTION:

The accommodation briefly comprises; entrance hall, two good sized reception rooms that have been opened to form a large dual aspect through reception room with bespoke alcove storage and leading to a luxury fitted kitchen with quartz worktops, integrated appliances, Quooker tap and stone tiled flooring. Upstairs to the first floor is a very large 14'0 x 13'9 master bedroom with 13'6 x 12'0 thirds bedroom with built in wardrobe and ample eaves storage, a fourth bedroom and modern shower room. To the rear is a lovely 37ft south facing garden with patio, flower beds, lawn and shed.

The property has been refurbished and extended by the current vendor and is in excellent decorative order. Features include: high ceilings, period features, herringbone wood flooring, double glazed windows, plantation shutters and gas fired central heating with feature radiators

This is a wonderful period home and viewing is a must. Video tour can be seen at Winkworth.co.uk

The property is located very close to the hugely popular Manor House Gardens with children's play park, a pond and a farmers market every Saturday. Just 200 metres away is the vibrant centre of Hither Green which includes a Sainsbury's Local, French Patisserie Cafe (La Delice), an incredible Deli and Bottle Shop (Found Hope Store), cocktail bar (Drink@Bob's) a florist (Otto's Greenhouse) and Italian restaurant and pizzeria (Sapore Vero), craft beer and chocolate shop (Park Fever), gastropub The Station Hotel and of course Hither Green Station giving access into Central London and London Bridge only 11 minutes away. There are several popular primary schools close by included the Ofsted "Outstanding" Brindishe Green Primary School, Colfes is just a 10 minutes' walk and there are school bus pickups on Handen Road for both Eltham College and Farringtons. Blackheath Village with its array of boutiques, bars and restaurants is also close by.





Ground Floor

Approx. 42.3 sq. metres (455.6 sq. feet)

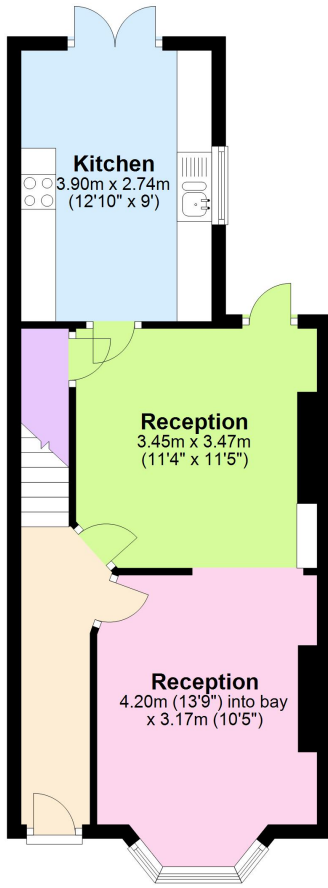

First Floor

Approx. 42.3 sq. metres (455.6 sq. feet)

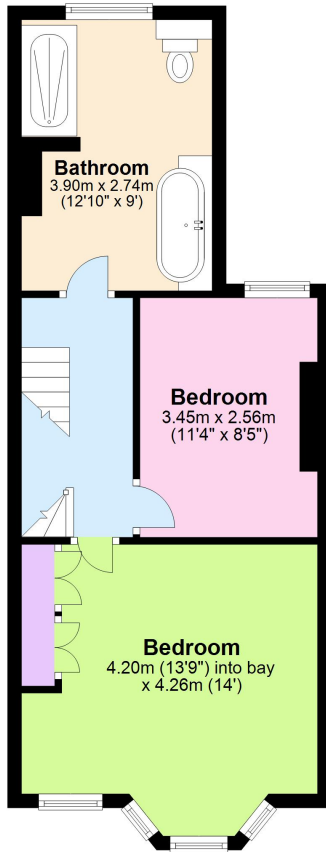

Second Floor

Approx. 30.8 sq. metres (331.3 sq. feet)

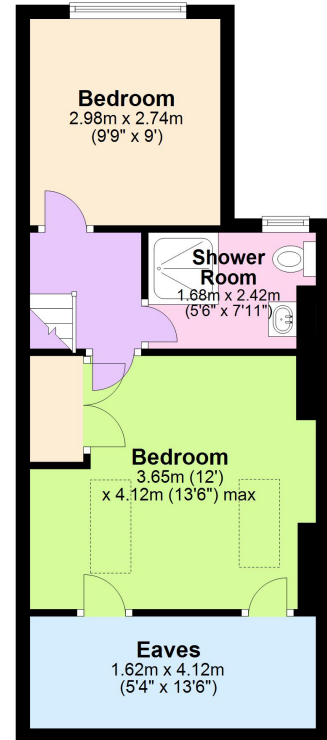

Total area: approx. 115.4 sq. metres (1242.5 sq. feet)

This floorplan is for illustration purposes only and is not to scale. The position and size of doors, windows, appliances and other features are approximate. Any lease and service charge details have been provided by the vendor. Any interest party should have these checked by a solicitor as part of the purchase process.

Blackheath | 0208 8520999 | blackheath@winkworth.co.uk

Winkworth

winkworth.co.uk

See things differently

Winkworth wishes to inform prospective buyers and tenants that these particulars are a guide and act as information only. All our details are given in good faith and believed to be correct at the time of printing but they don't form part of an offer or contract. No Winkworth employee has authority to make or give any representation or warranty in relation to this property. All fixtures and fittings, whether fitted or not are deemed removable by the vendor unless stated otherwise and room sizes are measured between internal wall surfaces, including furnishings.