

OAKLEIGH COURT, MURRAY GROVE, LONDON, N1
£120,000 LEASEHOLD

30% SHARED OWNERSHIP ONE BEDROOM APARTMENT WITH PRIVATE BALCONY

Islington | 0207 354 2480 | islington@winkworth.co.uk

Winkworth

winkworth.co.uk

See things differently



DESCRIPTION:

30 % SHARED OWNERSHIP. Located on the second floor of this modern, gated development set moments from Old Street is this fantastic one-bedroom flat. Accommodation comprises of a generous double bedroom, family bathroom and a wonderfully bright open-plan kitchen & reception room which leads directly out to a private balcony. The property further benefits from a secure underground parking space and is being offered to the market chain free.

Oakleigh Court is situated just off City road amongst the nest of recent award winning developments surrounding The Silicon Roundabout. Old Street station offers the closest underground links on the Northern line whilst the shops, bars and restaurants on Upper Street, Shoreditch and Clerkenwell are also close by. A variety of bus routes are at hand for easy access across London and international links are facilitated from St Pancras. You're also a stone's throw away from the ever-vibrant Regents Canal, perfect for leisurely strolls to Broadway market and beyond.

Winkworth



Winkworth

Oakleigh Court, Murray Grove, N1
 Approx. Gross Internal Floor Area 479 sq. ft / 44.51 sq. m

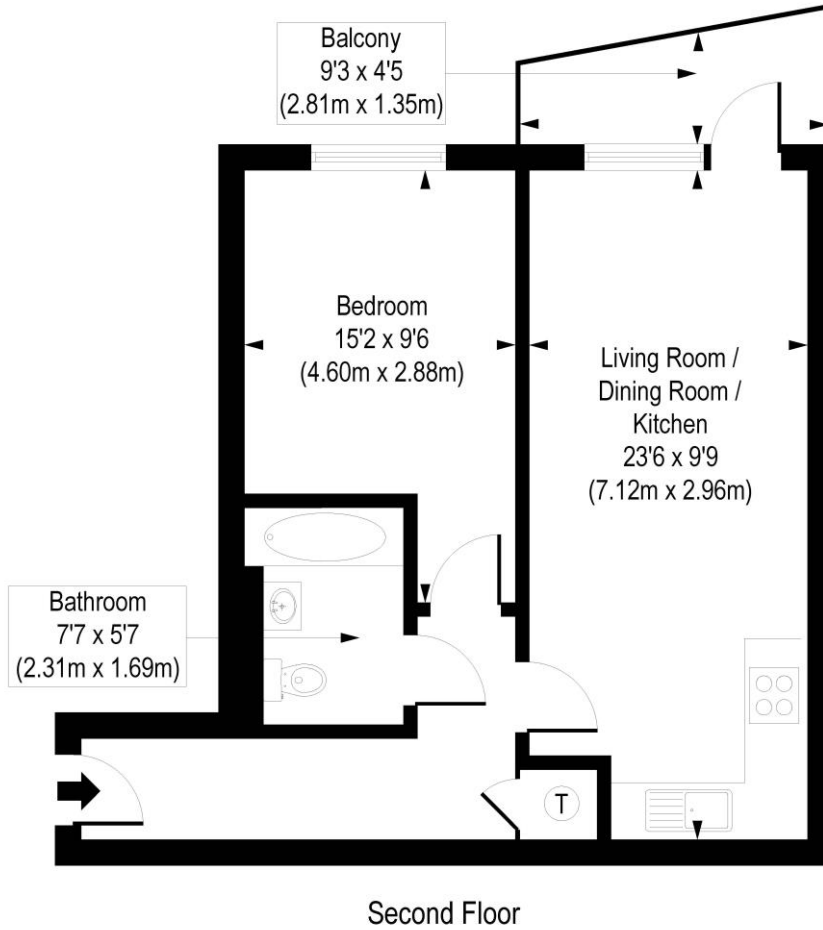
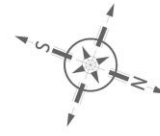

COMPLIANT WITH RICS CODE OF MEASURING PRACTICE. Floorplan is for illustrative purposes only and is not to scale. Every attempt has been made to ensure the accuracy of the floorplan shown, however all measurements, fixtures, fittings and data shown are an approximate interpretation for illustrative purposes only. Liability for errors, omissions or mis-statement through negligence or otherwise is hereby excluded.

This floorplan is for illustration purposes only and is not to scale. The position and size of doors, windows, appliances and other features are approximate.

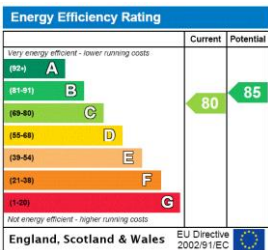

Islington | 0207 354 2480 | islington@winkworth.co.uk



winkworth.co.uk

See things differently

Winkworth wishes to inform prospective buyers and tenants that these particulars are a guide and act as information only. All our details are given in good faith and believed to be correct at the time of printing but they don't form part of an offer or contract. No Winkworth employee has authority to make or give any representation or warranty in relation to this property. All fixtures and fittings, whether fitted or not are deemed removable by the vendor unless stated otherwise and room sizes are measured between internal wall surfaces, including fumishings.