



201 Cutforth Way, Romsey, Hampshire, SO51 0BG

Winkworth



LOVELY ONE BEDROOM APARTMENT

A truly stunning recently built one bedroom apartment with a larger than average single garage in a quiet location enjoying a pleasant outlook within the Abbotswood estate. Locally within Abbotswood is a Co-op, hairdressers, café and takeaway. Romsey town centre and its extensive amenities are just a short drive away. The cathedral cities of Winchester and Salisbury are within easy commute. Along with the commercial centres of Southampton and Bournemouth, both with international airports. In addition there are good motorway and rail links to London and beyond.

The property is accessed via communal entrance with stairs leading to the first floor. A spacious hallway services the main rooms of the property comprising light and airy open plan sitting/dining room and kitchen with Juliet balcony enjoying views over the sports field to the nature reserve beyond. The kitchen is well equipped with integrated appliances. There is a good sized double bedroom and bathroom with shower over bath. Outside the property benefits from a large single garage.



Winkworth

Address: 201 Cutforth Way, Romsey,
Hampshire, SO51 0BG

Council Tax Banding: B



Cutforth Way

Approximate Gross Internal Area
Main House = 578 Sq Ft / 53.71 Sq M
Garage = 212 Sq Ft / 19.64 Sq M
Total = 790 Sq Ft / 73.35 Sq M

Outbuildings are not shown in correct orientation or location.

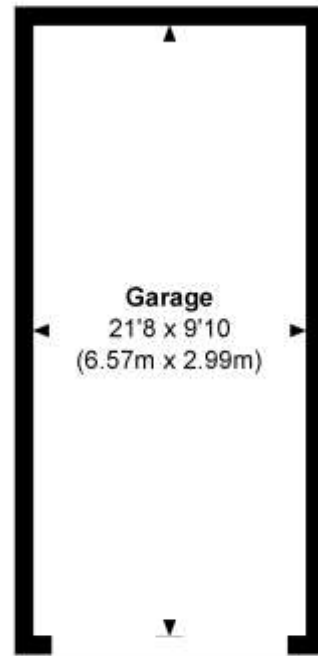

GARAGE

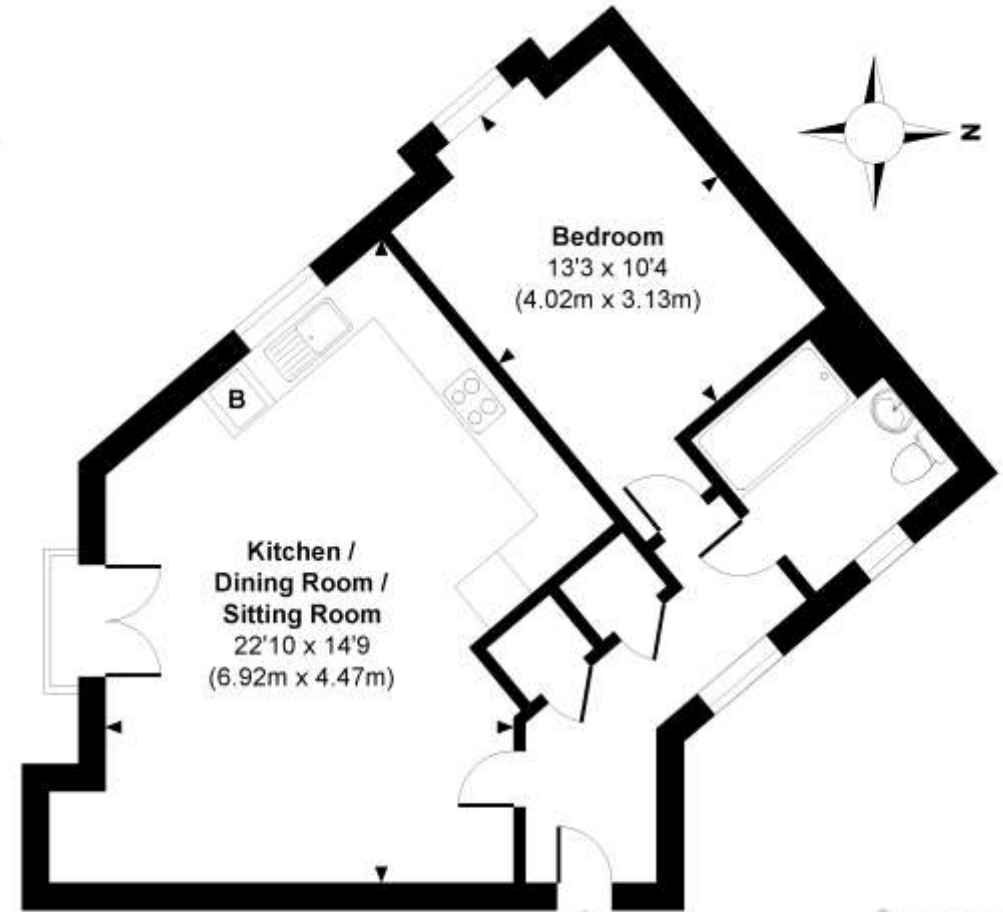

GROUND FLOOR

IN

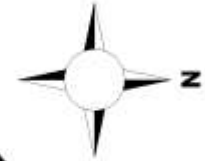

© www.propertyfocus.co.uk | Professional Property Photography & Floorplans
This plan is for illustrative purposes only and is not to scale. If specified, the Gross Internal Area (GIA), dimensions, floor
level orientation and the size and placement of features are approximate and should not be relied on as a statement of
fact. No guarantee is given for the GIA and no responsibility is taken for any error, omission or misrepresentation.

winkworth.co.uk/romsey

Winkworth Romsey

18 Market Place, Romsey, Hampshire, SO51 8NA
01794 511911 | romsey@winkworth.co.uk

winkworth.co.uk/romsey

Winkworth Winchester

2 Black Swan Buildings, Southgate Street,
Winchester, Hampshire, SO23 9DT
01962 866777 | winchester@winkworth.co.uk

Winkworth Mayfair & Country House Department

11 Berkeley Street, Mayfair, London, W1J 8DS
020 7871 0589 | countryhouse@winkworth.co.uk

Winkworth

See things differently