



WILTON SQUARE, LONDON, N1
£1,000,000 FREEHOLD

A THREE BEDROOM FREEHOLD HOUSE IN WILTON SQUARE, N1.

Stoke Newington | | stokenewington@winkworth.co.uk

Winkworth

winkworth.co.uk

See things differently



DESCRIPTION:

Set in one of Islington's most desirable locations is this wonderful three bedroom freehold house. The property offers any buyer great potential to renovate and create a truly stunning, one of a kind forever home. Positioned on the lower ground level is a kitchen, double bedroom and bathroom. There is a further kitchen and reception room on the raised ground floor, with the remaining two bedrooms located on the floor. The property is completed with a south-west facing garden and is offered to the market on a chain free basis.

Whilst situated on this wonderfully quiet garden square, the property is also within easy reach of the boutiques, bars and restaurants of Upper Street. The closest tube can be found at Angel station whilst Old Street and Essex road over ground are also within easy reach. Numerous bus routes provide easy access the City and West End whilst international travel is made easy from Kings Cross St Pancras.

Winkworth



Winkworth

Wilton Square, N1

Approx. Gross Internal Area 1206 Sq Ft - 112.04 Sq M

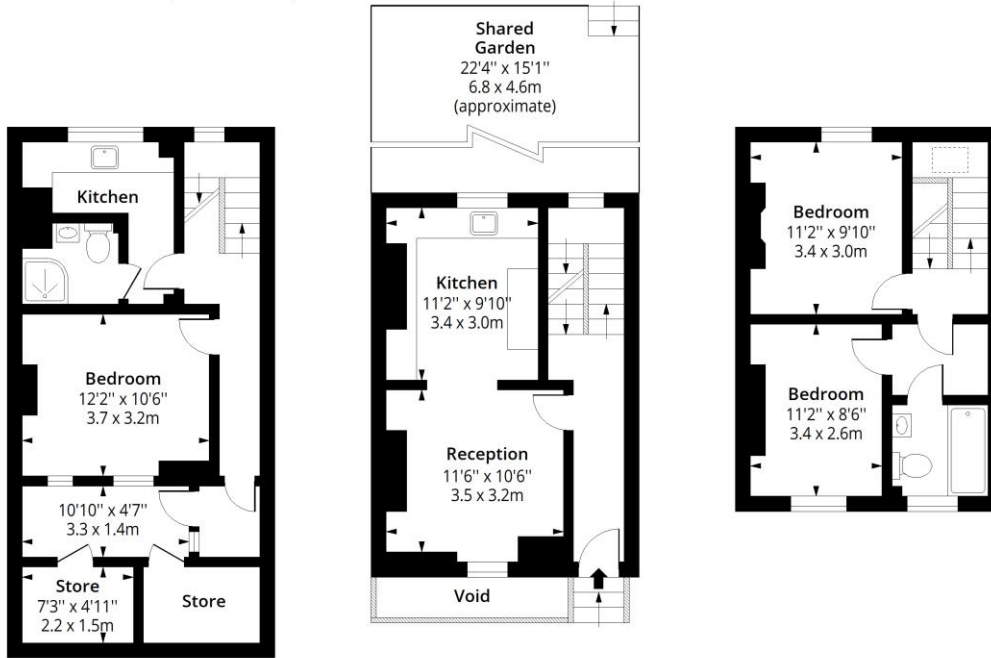

Basement

Floor Area 501 Sq Ft - 46.54 Sq M

Ground Floor

Floor Area 351 Sq Ft - 32.61 Sq M

First Floor

Floor Area 354 Sq Ft - 32.89 Sq M



Measured according to RICS IPMS2. Floor plan is for illustrative purposes only and is not to scale. Every attempt has been made to ensure the accuracy of the floor plan shown, however all measurements, fixtures, fittings and data shown are an approximate interpretation for illustrative purposes only. 1 sq m = 10.76 sq feet.

lplus.com

Date: 17/9/2024

This floorplan is for illustration purposes only and is not to scale. The position and size of doors, windows, appliances and other features are approximate.

Stoke Newington | | stokenewington@winkworth.co.uk

Winkworth

winkworth.co.uk

See things differently

Winkworth wishes to inform prospective buyers and tenants that these particulars are a guide and act as information only. All our details are given in good faith and believed to be correct at the time of printing but they don't form part of an offer or contract. No Winkworth employee has authority to make or give any representation or warranty in relation to this property. All fixtures and fittings, whether fitted or not are deemed removable by the vendor unless stated otherwise and room sizes are measured between internal wall surfaces, including furnishings.