



**HIGHBURY HILL, LONDON, N5**  
**£460 PER WEEK FURNISHED**

**A STUNNING ONE BEDROOM PERIOD FLAT BENEFITING FROM PRIVATE TERRACE AND GREAT LOCATION ON THE BEAUTIFUL TREE-LINED HIGHBURY HILL**

Islington | 0207 354 2480 | [islington@winkworth.co.uk](mailto:islington@winkworth.co.uk)

**Winkworth**

Tenant Fees Apply: Details of fees for tenant referencing, tenancy agreement admin fees and renewal fees are available on the Winkworth website and the link can be found with the displayed rent for the property. Tenants should ensure they are fully conversant with these upfront fees and other costs that are involved at the outset of the tenancy before making an offer to rent and your local Winkworth office will provide written details upon request.

[winkworth.co.uk](http://winkworth.co.uk)

See things differently



## DESCRIPTION:

This exquisite one double bedroom period conversion property is perfectly located in Highbury less than 200m from Arsenal tube Station and just 400m from Drayton Park Station.

The flat is spread across 600sq ft and provides abundant storage, masses of natural light and contemporary decor throughout. Its ultimate highlight is the large private roof terrace that is fully decked and includes a host of mature plants. The entry hall of the property leads to the stairway which opens up to the large open-plan living space encompassing reception room, modern kitchen and dining area. Off this large room is the spacious double bedroom that benefits from a good size fitted wardrobe. Finally there is the main bathroom with over-bath shower and modern fittings.

This highly desirable property is offered fully furnished and is perfect for professionals seeking a beautiful property to call home.

**Winkworth**



**Winkworth**

# Highbury Hill, N5

Approx. Gross Internal Floor Area 618 sq. ft / 57.49 sq. m

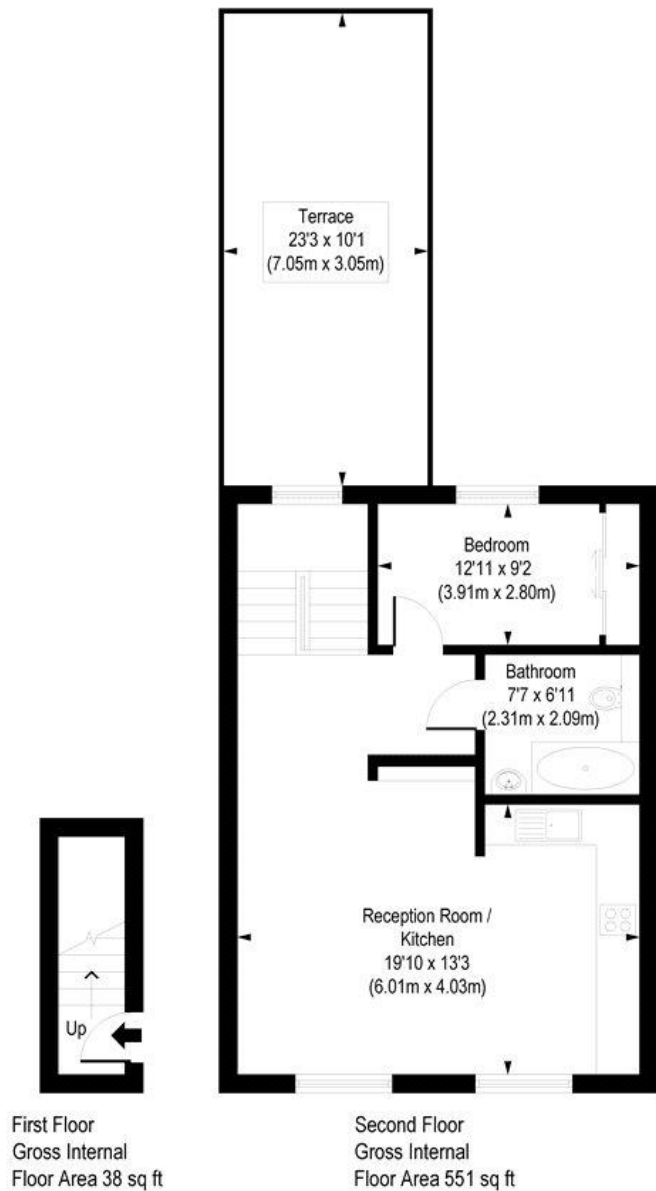
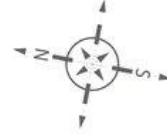

COMPLIANT WITH RICS CODE OF MEASURING PRACTICE. Floorplan is for illustrative purposes only and is not to scale. Every attempt has been made to ensure the accuracy of the floorplan shown, however all measurements, fixtures, fittings and data shown are an approximate interpretation for illustrative purposes only. Liability for errors, omissions or mis-statement through negligence or otherwise is hereby excluded.

This floorplan is for illustration purposes only and is not to scale. The position and size of doors, windows, appliances and other features are approximate.

Islington | 0207 354 2480 | [islington@winkworth.co.uk](mailto:islington@winkworth.co.uk)

**Winkworth**

[winkworth.co.uk](http://winkworth.co.uk)

See things differently

Winkworth wishes to inform prospective buyers and tenants that these particulars are a guide and act as information only. All our details are given in good faith and believed to be correct at the time of printing but they don't form part of an offer or contract. No Winkworth employee has authority to make or give any representation or warranty in relation to this property. All fixtures and fittings, whether fitted or not are deemed removable by the vendor unless stated otherwise and room sizes are measured between internal wall surfaces, including furnishings.