



DENTON HOUSE, BINGHAM COURT, N1  
OIEO £500,000 LEASEHOLD

## A LIGHT, WELL PROPORTIONED TWO BED FLAT SITUATED IN THE HEART OF ISLINGTON

Islington | 0207 354 2480 | [islington@winkworth.co.uk](mailto:islington@winkworth.co.uk)

**Winkworth**

[winkworth.co.uk](http://winkworth.co.uk)

See things differently



## DESCRIPTION:

A wonderful two bedroom apartment set across the first floor of this popular development in Islington, N1. Standing at 532sqft, the property offers is flooded with natural light and has well-proportioned rooms throughout. Accommodation comprises of two double bedrooms, the master bedroom benefitting from inbuilt storage. The separate, modern kitchen includes integrated appliances and has plentiful countertop space. The reception room faces the quiet, leafy street that is Halton Road and benefits from a private balcony.

Denton House is situated in a prime location on a residential street just walking distance to Upper Street and its many boutique's and restaurants, with easy access to both Angel (Northern Line) and Highbury and Islington (Victoria, North London and Northern City Lines) stations. It is also just moments from Essex Road station which takes you straight to into the city.

**Winkworth**



Winkworth

# Denton House, Halton Road, N1

Approx. Gross Internal Floor Area 532 sq. ft / 49.46 sq. m

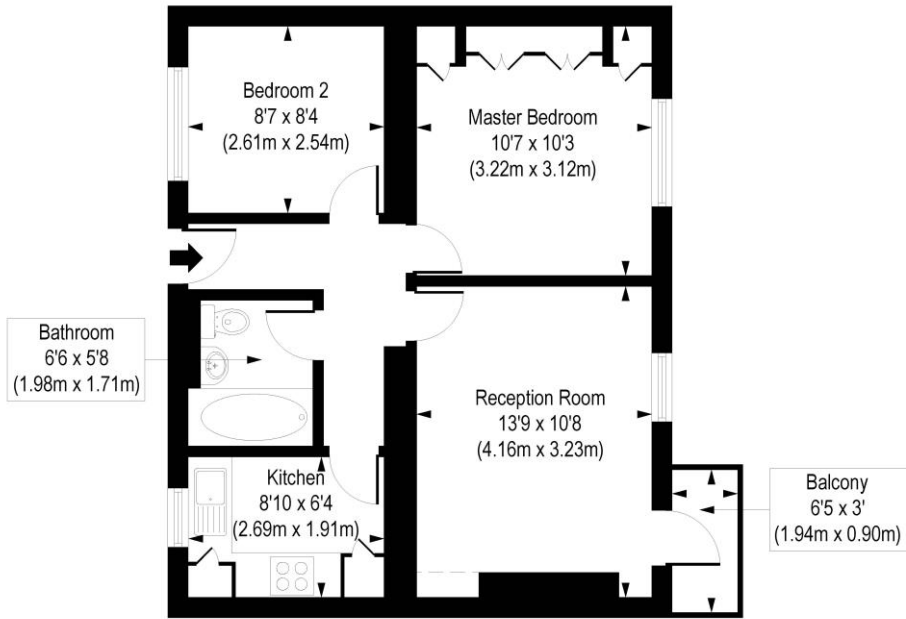
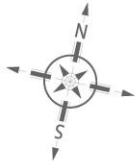

First Floor

COMPLIANT WITH RICS CODE OF MEASURING PRACTICE. Floorplan is for illustrative purposes only and is not to scale. Every attempt has been made to ensure the accuracy of the floorplan shown, however all measurements, fixtures, fittings and data shown are an approximate interpretation for illustrative purposes only. Liability for errors, omissions or mis-statement through negligence or otherwise is hereby excluded.

This floorplan is for illustration purposes only and is not to scale. The position and size of doors, windows, appliances and other features are approximate.

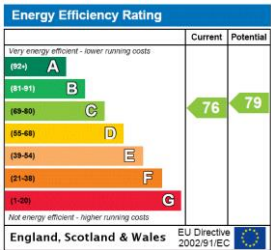

Islington | 0207 354 2480 | [islington@winkworth.co.uk](mailto:islington@winkworth.co.uk)



[winkworth.co.uk](http://winkworth.co.uk)

See things differently

Winkworth wishes to inform prospective buyers and tenants that these particulars are a guide and act as information only. All our details are given in good faith and believed to be correct at the time of printing but they don't form part of an offer or contract. No Winkworth employee has authority to make or give any representation or warranty in relation to this property. All fixtures and fittings, whether fitted or not are deemed removable by the vendor unless stated otherwise and room sizes are measured between internal wall surfaces, including furnishings.