



## ELGIN CRESCENT, W11

**£750 PER WEEK (£3,250.00 PCM) Unfurnished**

**A WONDERFULLY SPACIOUS AND BEAUTIFULLY REFURBISHED ONE DOUBLE BEDROOM FLAT ON THE SECOND FLOOR OF THIS PERIOD BUILDING WITH THE ADDED BENEFIT OF ACCESS AND USE OF THE STUNNING COMMUNAL GARDENS BEHIND.**

Long Let, 1 Bedroom, 1 Reception Room, 1 Bathroom, Flat/Apartment, Upper Floor without Lift, Communal Gardens, Unfurnished

**Winkworth**



### DESCRIPTION:

The property comprises hallway with utility cupboard housing a separate washer and dryer, well-proportioned living room with built in media cupboard and a separate fully fitted kitchen. The property further comprises a wonderfully spacious double bedroom with fitted wardrobes and sought-after view of the communal gardens behind and an immaculate bathroom with shower over bath. The property is offered unfurnished and viewings are highly recommended.

### LOCATION:

Elgin Crescent is a highly desirable, imposing crescent to the west of Ladbrooke Grove, a short walk from the many restaurants and boutiques around Kensington Park Road and a within easy walking distance of Notting Hill Gate and Holland Park underground stations.

### LOCAL AUTHORITY AND COUNCIL TAX BAND:

Royal Borough of Kensington & Chelsea (Band F)



# Elgin Crescent, W11

Approximate Gross Internal Area  
55.3 sq m / 595 sq ft

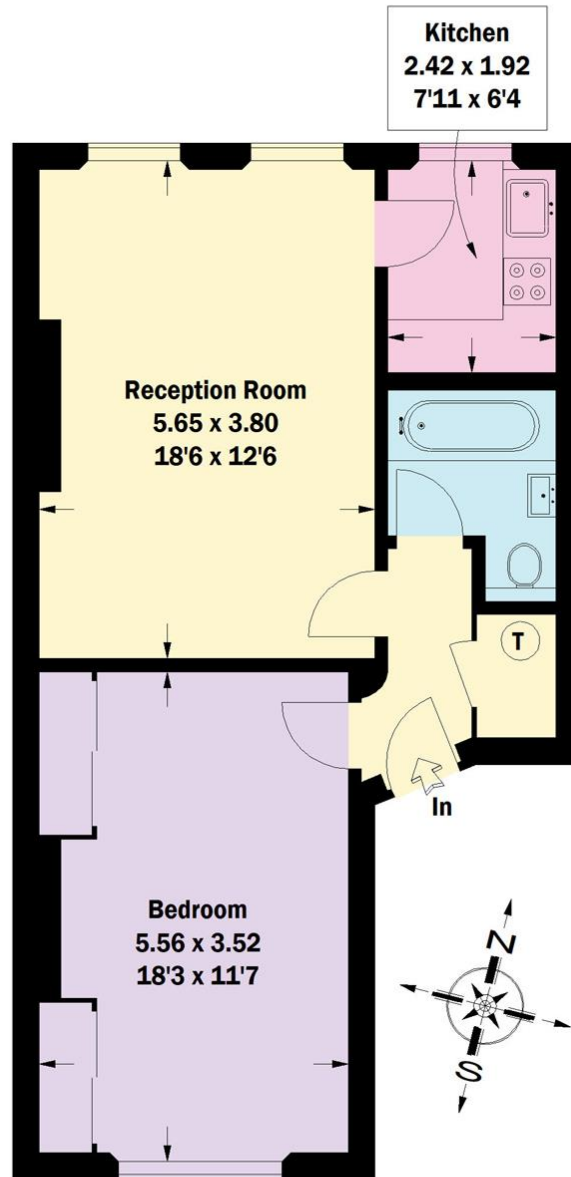

## Second Floor

Whilst every attempt has been made to ensure the accuracy of the floor plan, measurements are approximate and not to scale. No guarantee is given on the total square footage of the property quoted on the plan. Figures given are for guidance. Plan is for illustration purposes only, not to be used for valuations.

This floorplan is for illustration purposes only and is not to scale. The position and size of doors, windows, appliances and other features are approximate.

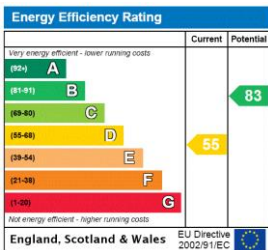

Notting Hill | 0207 727 3227 | nottinghill@winkworth.co.uk

Winkworth

winkworth.co.uk

for every step...

winkworth wishes to inform prospective buyers and tenants that these particulars are a guide and act as information only. All our details are given in good faith and believed to be correct at the time of printing but they don't form part of an offer or contract. No Winkworth employee has authority to make or give any representation or warranty in relation to this property. All fixtures and fittings, whether fitted or not are deemed removable by the vendor unless stated otherwise and room sizes are measured between internal wall surfaces, including furnishings.