



PETERS COURT, LONDON, W2

**£395 PER WEEK £1,711.67 PER MONTH PART FURNISHED**

**AN IMMACULATE AND VERY SPACIOUS STUDIO  
FLAT ON THE FIRST FLOOR OF THIS PORTED  
BUILDING WITH LIFT.**

Notting Hill Lettings | 020 77273227 | nottinghill@winkworth.co.uk

**Winkworth**

for every step...

*winkworth.co.uk*



**DESCRIPTION:**

The property comprises original wood parquet floor, bay window, separate fitted kitchen and immaculate newly refurbished bathroom.

The property benefits from a built-in pull down double bed and hot water and heating included in the rent and the property is available immediately.





## Peters Court

Approximate Gross Internal Area = 298 sq ft / 27.7 sq m

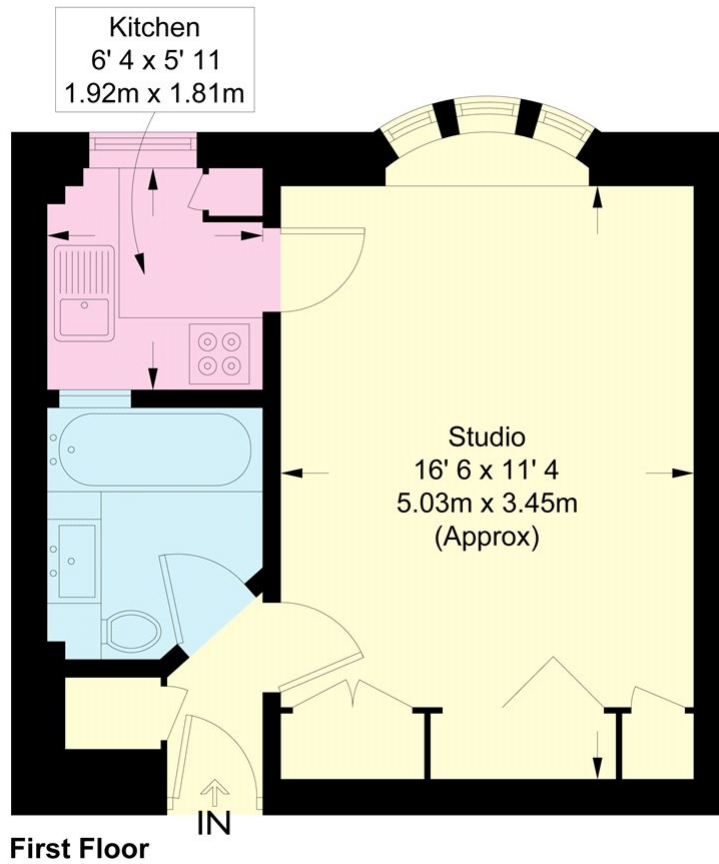

Not to scale, for guidance only and must not be relied upon as a statement of fact  
All measurements and areas are approximate only and have been prepared in  
accordance with the current edition of the RICS Code of Measuring Practice

This floorplan is for illustration purposes only and is not to scale. The position and size of doors, windows, appliances and other features are approximate.

**Deposit:** £ 1,975

**Holding Deposit:** Weeks rent

**Council Tax Band:** B

Where no figures are shown, we have been unable to ascertain the information. All figures that are shown were correct at the time of printing.

Notting Hill Lettings | 020 77273227 | nottinghill@winkworth.co.uk

**Winkworth**

for every step...

[winkworth.co.uk](http://winkworth.co.uk)

Winkworth wishes to inform prospective buyers and tenants that these particulars are a guide and act as information only. All our details are given in good faith and believed to be correct at the time of printing but they don't form part of an offer or contract. No Winkworth employee has authority to make or give any representation or warranty in relation to this property. All fixtures and fittings, whether fitted or not are deemed removable by the vendor unless stated otherwise and room sizes are measured between internal wall surfaces, including furnishings.