



EGERTON GARDENS, LONDON, NW10
£1,499,950 FREEHOLD

**A LOVELY FOUR BEDROOM FAMILY HOME MEASURING
1746 SQ.FT IN THIS GREAT LITTLE CUL-DE-SAC IN
KENSAL RISE**

Kensal Rise & Queens Park | 0208 960 4947 | kensalrise@winkworth.co.uk





LOCATION:

Kensal Rise is a vibrant and desirable area in North West London, known for its friendly community atmosphere, excellent transport links, and eclectic mix of amenities. Popular with families, professionals, and creatives alike, the area seamlessly combines a relaxed village vibe with the convenience of urban living. The heart of Kensal Rise is its bustling high street, Chamberlayne Road, which offers an array of independent boutiques, stylish cafes, trendy restaurants, and lively pubs. Whether you're looking for artisanal coffee, unique homewares, or a delicious meal, the area has something to suit all tastes. For foodies, there are plenty of options, from cozy brunch spots to high-quality international cuisine. For outdoor enthusiasts, Queens Park, Tiverton Park and King Edwards Park provide beautiful green spaces for picnics, jogging, or leisurely walks. Queen's Park is particularly family-friendly, featuring a children's playground, tennis courts, and even a small petting zoo. The area is well-connected, with the Overground station offering swift links to central London, making it an excellent location for commuters. Additional transport options include multiple bus routes and easy access to nearby Kensal Green Station, which is served by the Bakerloo Line.



Winkworth



DESCRIPTION:

Situated on the highly sought-after Egerton Gardens in Kensal Rise, this charming 1930s semi-detached home offers an exceptional blend of period character and modern convenience. Spanning an impressive 1,764 sq. ft., the property boasts four generously sized bedrooms, making it an ideal choice for families or those seeking versatile living space. The home features well-proportioned reception rooms filled with natural light, high ceilings, and bay windows that highlight its timeless 1930s design. Original details such as fireplaces, cornicing, and wood flooring add a sense of heritage and warmth throughout. The bright and spacious kitchen/diner has been thoughtfully updated with modern fittings, creating a welcoming space for family meals and entertaining. To the rear, a mature private garden provides a peaceful retreat with ample room for outdoor relaxation, gardening, or hosting gatherings. Egerton Gardens is a quiet, tree-lined street in a prime location, offering excellent transport links, access to outstanding schools, and a vibrant community with a wide array of local amenities just a short stroll away.

Winkworth

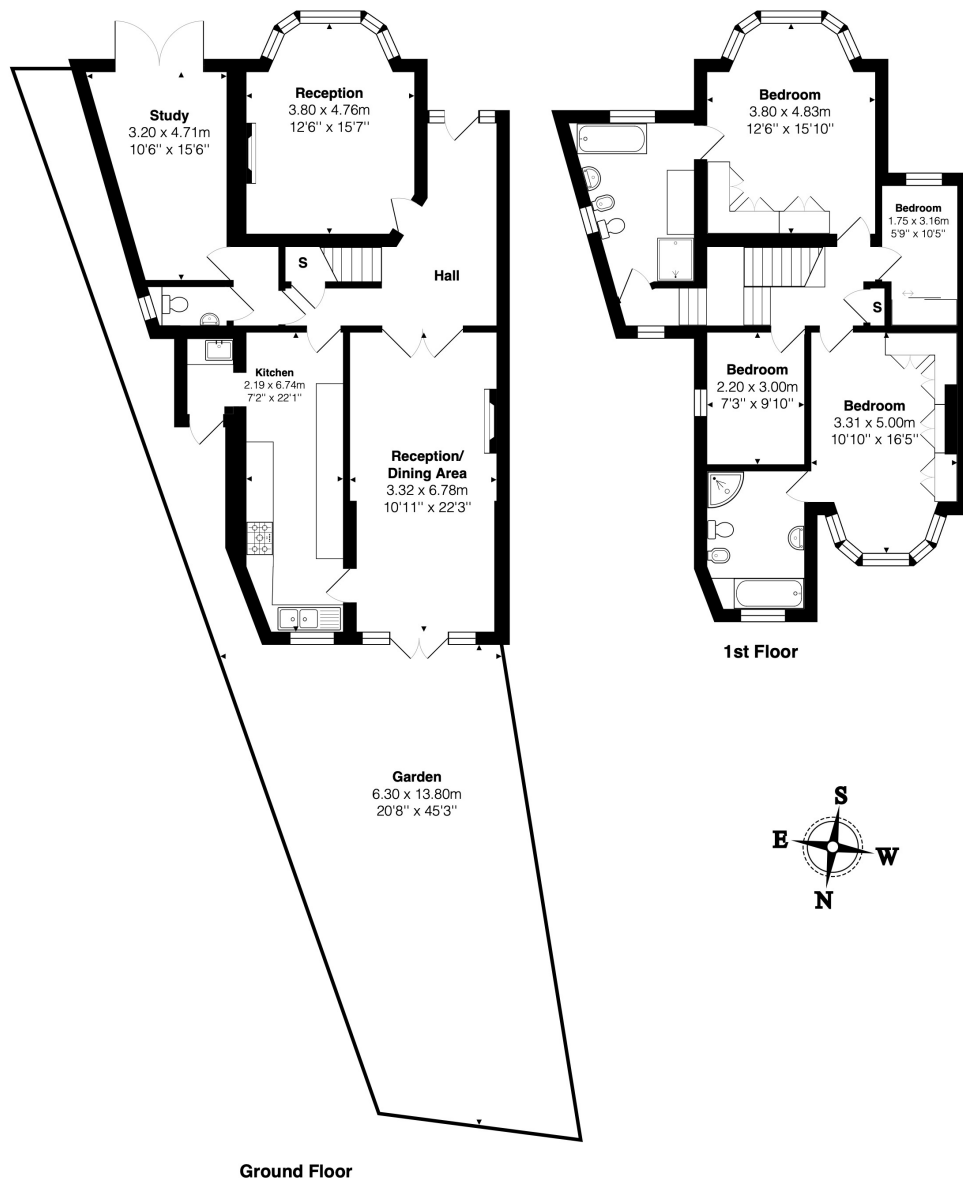

Ground Floor

1st Floor

Total Area: 162.2 m² ... 1746 ft² (excluding garden)

All measurements are approximate and for display purposes only

This floorplan is for illustration purposes only and is not to scale. The position and size of doors, windows, appliances and other features are approximate.

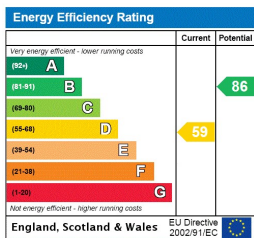

Kensal Rise & Queens Park | 0208 960 4947 | kensalrise@winkworth.co.uk

Winkworth

winkworth.co.uk

See things differently

winkworth wishes to inform prospective buyers and tenants that these particulars are a guide and act as information only. All our details are given in good faith and believed to be correct at the time of printing but they don't form part of an offer or contract. No winkworth employee has authority to make or give any representation or warranty in relation to this property. All fixtures and fittings, whether fitted or not are deemed removable by the vendor unless stated otherwise and room sizes are measured between internal wall surfaces, including furnishings.