



BEVERLEY DRIVE, EDGWARE, MIDDLESEX, HA8  
**£700,000 FREEHOLD**

## THREE BEDROOM DETACHED HOUSE - DEVELOPMENT PROJECT

Kingsbury | 020 8204 0000 | [kingsbury@winkworth.co.uk](mailto:kingsbury@winkworth.co.uk)

**Winkworth**

for every step...

[winkworth.co.uk](http://winkworth.co.uk)



**DESCRIPTION:** Beautifully positioned in the highly sought-after Beverley Drive Estate, this detached three-bedroom house presents amazing scope for redevelopment and substantial extension (STPP). Lovingly cherished by generations for decades, the property exudes character and awaits new owners to bring their creative vision to life. It sits within the catchment area for reputable local schools and transport links making it ideal for families and commuters. Additional features include a beautiful and well-maintained garden, a garage, and off-street parking. An internal viewing is highly recommended to fully appreciate the potential this property has to offer.



for every step...



Winkworth  
for every step...



Winkworth  
for every step...



Winkworth  
for every step...

**Winkworth**

for every step...

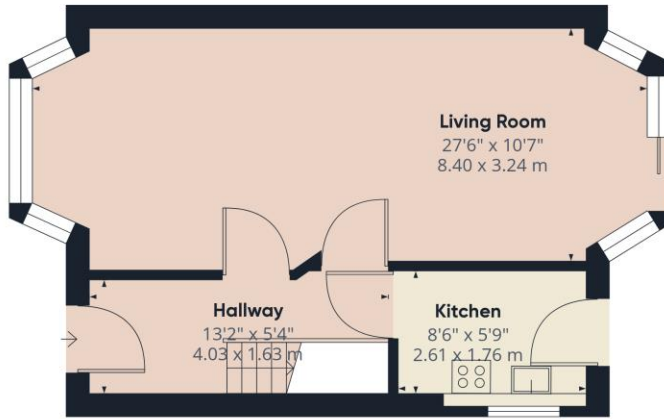

Ground Floor

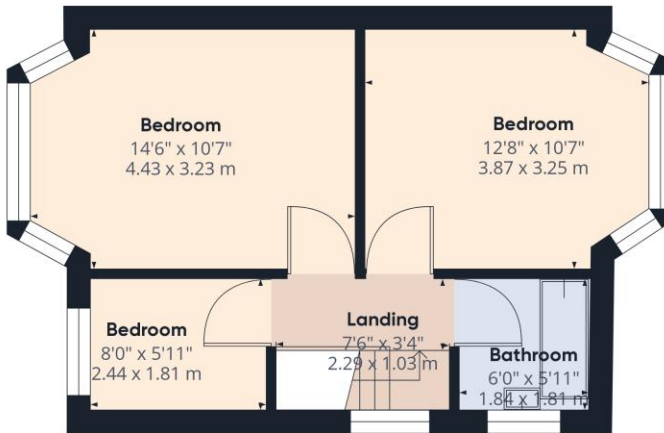

Floor 1

**Approximate total area<sup>(1)</sup>**  
 807.08 ft<sup>2</sup>  
 74.98 m<sup>2</sup>

(1) Excluding balconies and terraces

While every attempt has been made to ensure accuracy, all measurements are approximate, not to scale. This floor plan is for illustrative purposes only.  
 Calculations are based on RICS IPMS 3C standard.

GIRAFFE360

This floorplan is for illustration purposes only and is not to scale. The position and size of doors, windows, appliances and other features are approximate.

**Tenure:** Freehold

**Council Tax Band:** E - Brent

Where no figures are shown, we have been unable to ascertain the information. All figures that are shown were correct at the time of printing.

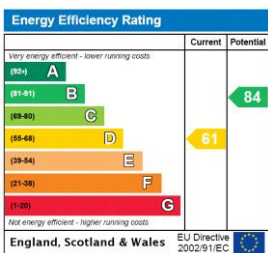

Kingsbury | 020 8204 0000 | kingsbury@winkworth.co.uk



for every step...

winkworth.co.uk

Winkworth wishes to inform prospective buyers and tenants that these particulars are a guide and act as information only. All our details are given in good faith and believed to be correct at the time of printing but they don't form part of an offer or contract. No Winkworth employee has authority to make or give any representation or warranty in relation to this property. All fixtures and fittings, whether fitted or not are deemed removable by the vendor unless stated otherwise and room sizes are measured between internal wall surfaces, including furnishings.