



FLAT B, ST. CLEMENTS CHURCH HALL, DAVEY CLOSE, LONDON, N7
£625,000 LEASEHOLD

A WONDERFUL, ONE BEDROOM MAISONETTE IDEALLY LOCATED IN BARNSBURY

Highbury | 0207 989 7000 | highbury@winkworth.co.uk

Winkworth

winkworth.co.uk

See things differently



DESCRIPTION:

A stunning one bedroom maisonette located in St. Clements Church Hall next to Arundel Square, Barnsbury. Arranged over the ground and first floor, the property benefits from its own private entrance with spacious and contemporary fitted kitchen to the front and living room with private south west facing patio space to the rear. Upstairs there is a large double bedroom, benefitting from in built wardrobes and a charming balcony. A stylish bathroom can also be found on the first floor. The apartment is sold with a share of the freehold and has access to a communal courtyard and bike storage.

St. Clements Church Hall is ideally located for easy access to the City and the West End and is set moments from the many bars, restaurants and boutique shops on Upper Street. The closest transport links can be found at Highbury and Islington (Victoria Line) with Caledonian Road Underground (Piccadilly Line) also within easy reach. Overground services are located at Caledonian Road and Barnsbury whilst international transport is facilitated from Kings Cross St. Pancras.

*Any associated charges including, but not limited to, service charge, ground rent and sinking funds

Winkworth



Winkworth

St. Clements Church Hall, Davey Close, N7

Approx. Gross Internal Floor Area 639 sq. ft / 59.41 sq. m

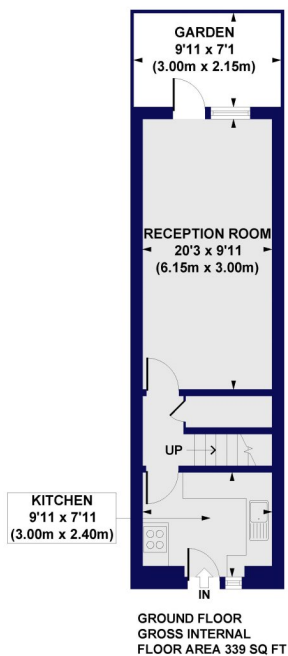
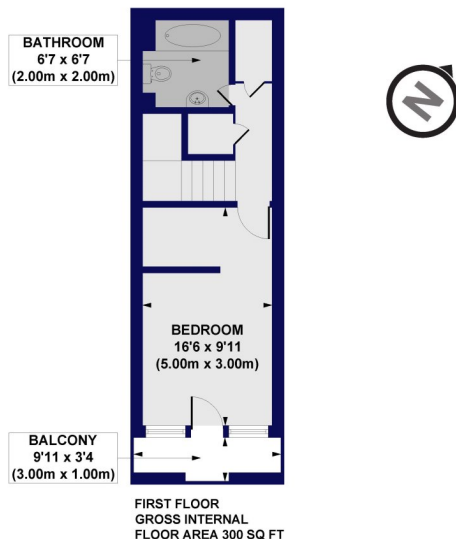

All measurements of walls, doors, windows, fittings and appliances, including their size and location, are shown as standard sizes and do not constitute any warranty or representation by the seller, their agent or CP Creative. Any intending purchaser must satisfy himself by inspection or otherwise as to the correctness of the information contained in these plans. This plan is for illustrative purposes only and should be used as such by any prospective purchasers.

Winkworth

This floorplan is for illustration purposes only and is not to scale. The position and size of doors, windows, appliances and other features are approximate.

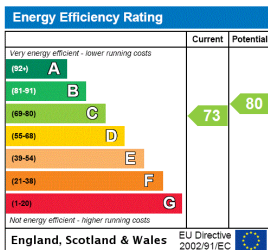

Highbury | 0207 989 7000 | highbury@winkworth.co.uk



winkworth.co.uk

See things differently

Winkworth wishes to inform prospective buyers and tenants that these particulars are a guide and act as information only. All our details are given in good faith and believed to be correct at the time of printing but they don't form part of an offer or contract. No Winkworth employee has authority to make or give any representation or warranty in relation to this property. All fixtures and fittings, whether fitted or not are deemed removable by the vendor unless stated otherwise and room sizes are measured between internal wall surfaces, including furnishings.