



SEBBON STREET, LONDON, N1  
£625,000 LEASEHOLD

**A GENEROUSLY SIZED THREE BEDROOM, TOP FLOOR FLAT IN THE HEART OF ISLINGTON.**

Islington | 0207 354 2480 | [islington@winkworth.co.uk](mailto:islington@winkworth.co.uk)

**Winkworth**

[winkworth.co.uk](http://winkworth.co.uk)

See things differently





## DESCRIPTION:

Spanning almost 800sqft is this wonderful three double bedroom apartment positioned on the top floor of this well-maintained block. Accommodation includes a kitchen, bathroom, three double bedrooms and a private balcony. The property further benefits from a long lease is offered to the market chain free.

Sebbon Street is perfectly located just moments from an array of bars, restaurants and boutique shops on Upper Street as well as the supermarkets in Angel. Transport links are some of the best around with Highbury and Islington offering Overground options and Underground services on the Victoria line as well as the Northern line at Angel. National Rail services are available from Essex Road station and a fantastic selection of bus routes are on hand for effortless access across London.

**Winkworth**





Winkworth

# Sebbon Street, N1

Approx. Gross Internal Floor Area 789 sq. ft / 73.33 sq. m

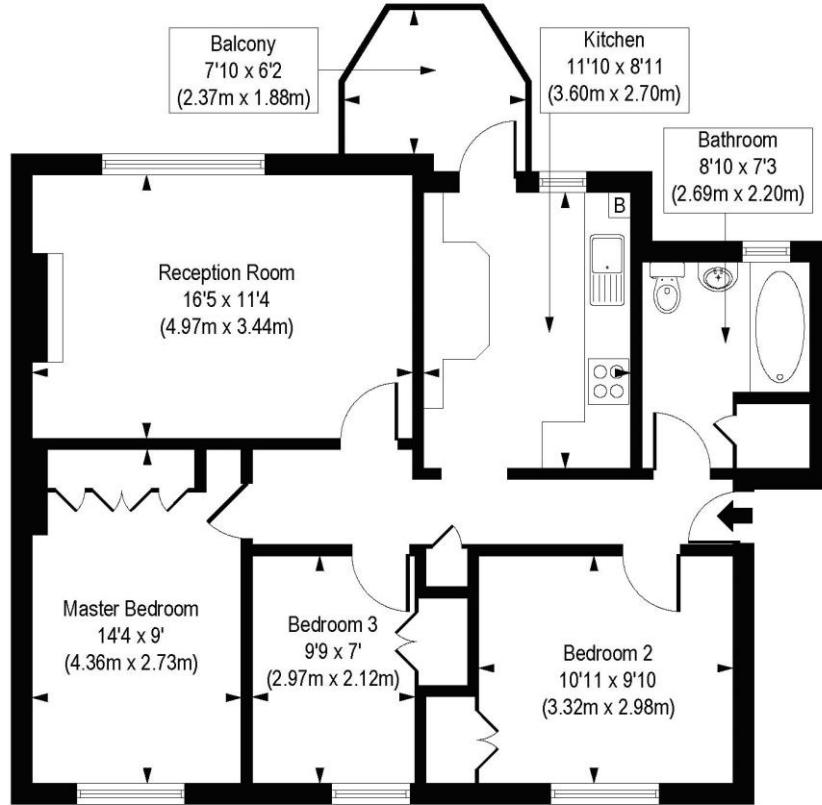

Third Floor

COMPLIANT WITH RICS CODE OF MEASURING PRACTICE. Floorplan is for illustrative purposes only and is not to scale. Every attempt has been made to ensure the accuracy of the floorplan shown, however all measurements, fixtures, fittings and data shown are an approximate interpretation for illustrative purposes only. Liability for errors, omissions or mis-statement through negligence or otherwise is hereby excluded.

This floorplan is for illustration purposes only and is not to scale. The position and size of doors, windows, appliances and other features are approximate.

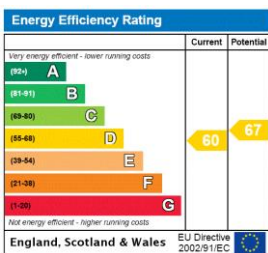

Islington | 0207 354 2480 | islington@winkworth.co.uk



winkworth.co.uk

See things differently

Winkworth wishes to inform prospective buyers and tenants that these particulars are a guide and act as information only. All our details are given in good faith and believed to be correct at the time of printing but they don't form part of an offer or contract. No Winkworth employee has authority to make or give any representation or warranty in relation to this property. All fixtures and fittings, whether fitted or not are deemed removable by the vendor unless stated otherwise and room sizes are measured between internal wall surfaces, including furnishings.