



RIDGMOUNT ROAD, SW18
£5,500 PER MONTH

An elegant five bedroom family home situated on a quiet residential street in Wandsworth

Putney | 020 8877 1000 | putney@winkworth.co.uk

Winkworth

for every step...

winkworth.co.uk



DESCRIPTION:

Situated in a leafy residential cul-de-sac this house extends to over 2,250 sq. ft. and is stylishly presented throughout.

A welcoming entrance hall greets you, leading through to a large double reception room with original wood flooring, three metre ceilings, fitted cabinetry and feature fireplace. At the rear is an impressive kitchen/dining room with island and underfloor heating. Velux windows and wall-to-wall sliding glass doors provide an abundance of natural light. There is also a guest w/c and extensive cellar providing additional storage. A generous garden with decked area for alfresco dining and artificial lawn perfect for children offers excellent privacy for a family to enjoy.

The first floor comprises three double bedrooms, all with built-in wardrobes, and a family bathroom with underfloor heating. There are two further double bedrooms, and two bathrooms, including a stunning loft conversion on the second floor with considerable wardrobes and eaves storage, and luxurious ensuite bathroom with free-standing bath and walk-in shower.

Ridgmount Road is conveniently located for the green open spaces of Wandsworth Common and the shops, cafes and restaurants of East Hill and Wandsworth Town. There are excellent schools and transport facilities nearby including All Farthing Primary School (0.3 miles) and Wandsworth Town Station (0.5 miles). Southside Shopping Centre is within easy reach.



Ridgmount Road, SW18

Approx. Gross Internal Area 210.33 sq m / 2264 sq ft (Including Eaves Storage)
 Approx. Gross Internal Area 196.58 sq m / 2116 sq ft (Excluding Eaves Storage)

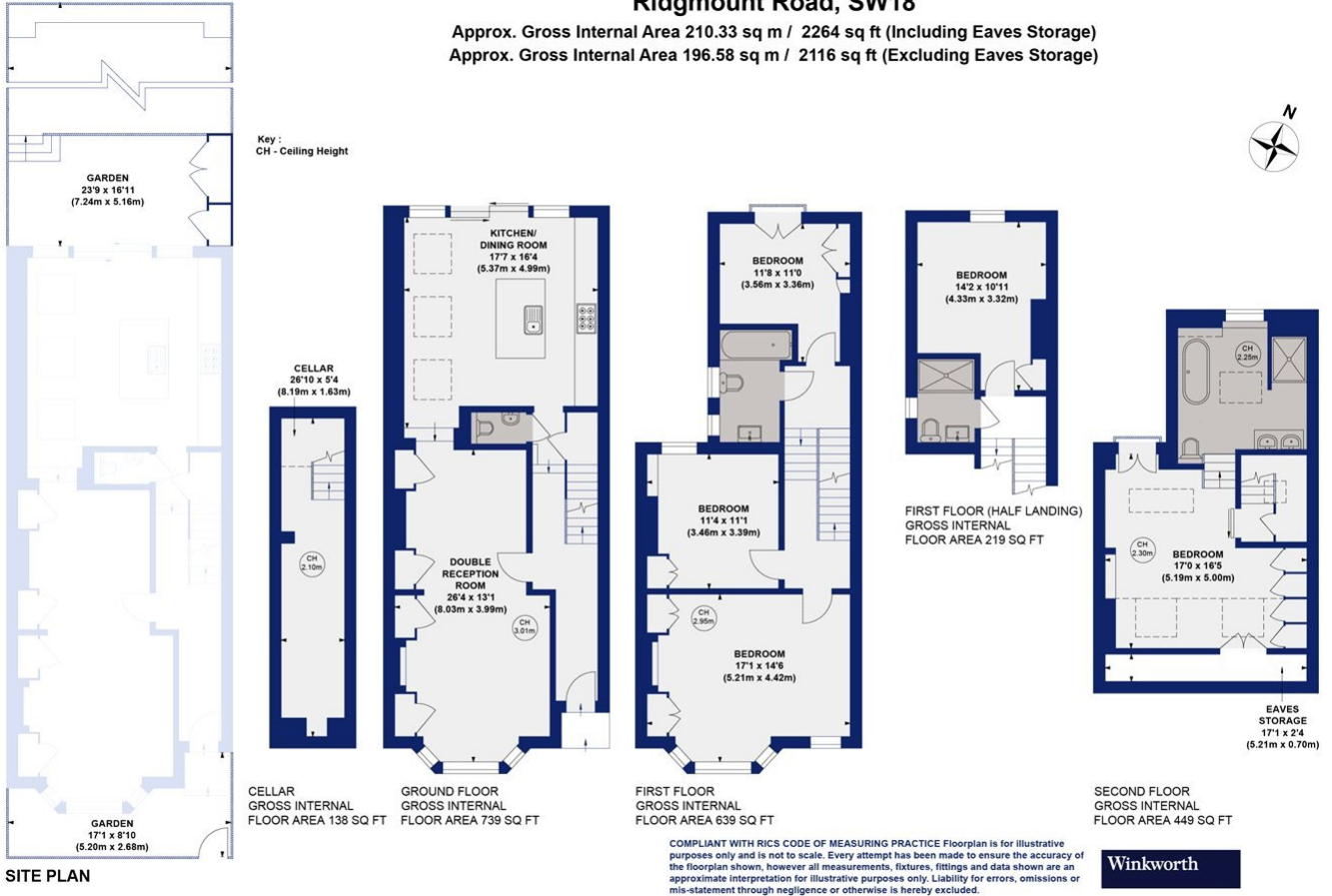

This floorplan is for illustration purposes only and is not to scale. The position and size of doors, windows, appliances and other features are approximate.

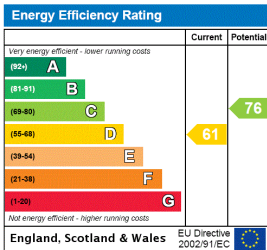

Deposit: £7,615.38

Holding Deposit: 1 week's rent

Council Tax Band: Wandsworth

Where no figures are shown, we have been unable to ascertain the information. All figures that are shown were correct at the time of printing.



for every step...

Putney | 020 8877 1000 | putney@winkworth.co.uk

winkworth.co.uk

Winkworth wishes to inform prospective buyers and tenants that these particulars are a guide and act as information only. All our details are given in good faith and believed to be correct at the time of printing but they don't form part of an offer or contract. No Winkworth employee has authority to make or give any representation or warranty in relation to this property. All fixtures and fittings, whether fitted or not are deemed removable by the vendor unless stated otherwise and room sizes are measured between internal wall surfaces, including furnishings.