



LORDSHIP LANE, EAST DULWICH, LONDON, SE22
£475,000 LEASEHOLD

A BEAUTIFUL, TWO DOUBLE BEDROOM FIRST FLOOR FLAT, SITUATED IN A SOUGHT AFTER LOCATION IN SE22.

Dulwich | 020 8299 2722 | dulwich@winkworth.co.uk

Winkworth

Tenure Leasehold approx. 117 yrs remaining | Council Tax Band C – London Borough of Southwark | Service Charge £293 pa | Ground Rent £300 pa

winkworth.co.uk

See things differently



DESCRIPTION:

Situated on a sought-after part of Lordship Lane. This delightful property offers a perfect blend of modern living and convenient access to the best of East Dulwich. Boasting an abundance of natural light the property features a spacious open-plan modern fitted, kitchen/reception. The property has been refurbished to a high standard throughout and also boasts a private garden.

The property is situated in an incredibly sought after location, close to the hustle and bustle of Lordship Lane, the parks at Dulwich Park, Goose Green and Peckham Rye park. The property benefits from a bus stop in both directions directly outside, easy access to London bridge can be found via East Dulwich station, Denmark Hill station for the overground or Forest Hill for the East London line. This is a superb flat in a prime location.

AT A GLANCE

- Two Double Bedrooms
- Modern Open Plan Kitchen/Reception
- Modern Bathroom
- Refurbished To a High Standard
- Prime Location

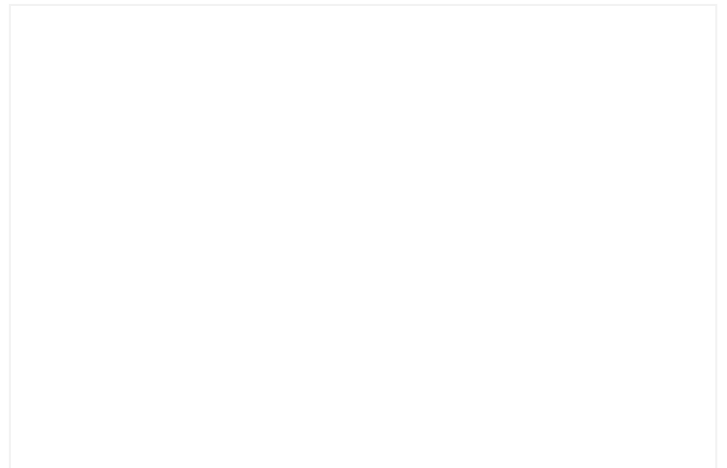
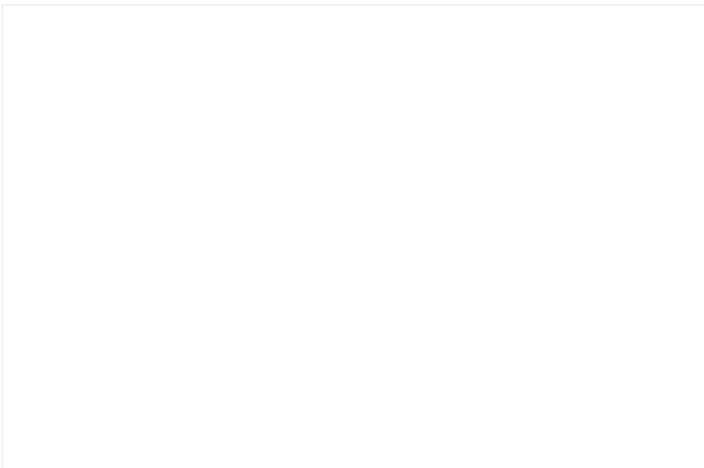



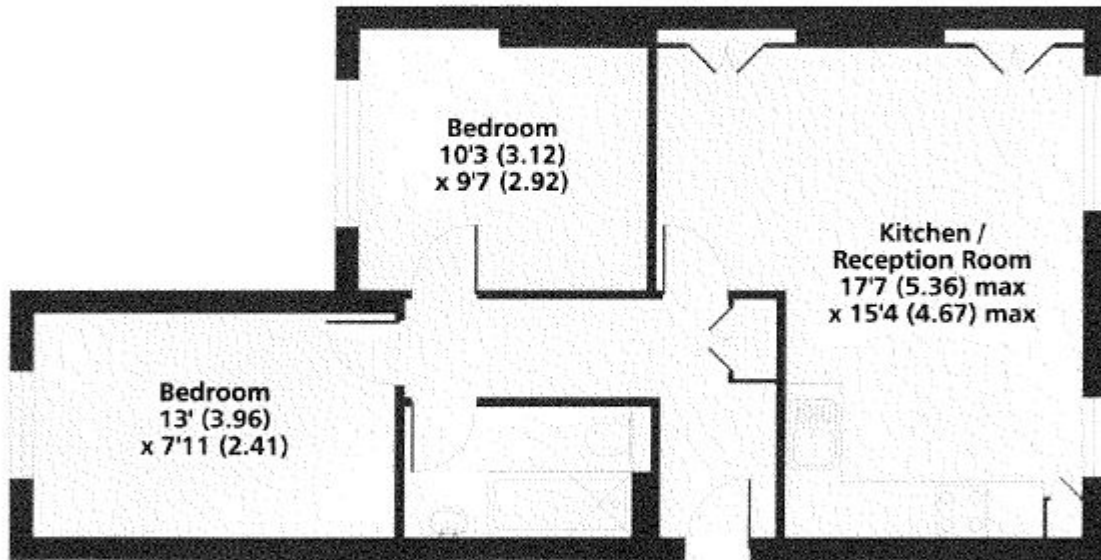
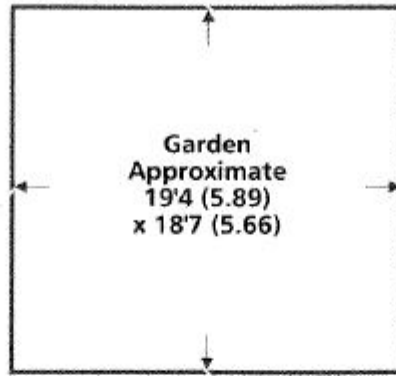

First Floor

Lordship Lane, SE22
 Approximate Area = 558 sq ft / 51.8 sq m
 For identification only - Not to scale

This floorplan is for illustration purposes only and is not to scale. The position and size of doors, windows, appliances and other features are approximate.

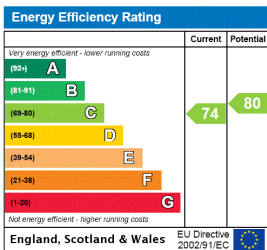

Dulwich | 020 8299 2722 | dulwich@winkworth.co.uk



winkworth.co.uk

See things differently

Winkworth wishes to inform prospective buyers and tenants that these particulars are a guide and act as information only. All our details are given in good faith and believed to be correct at the time of printing but they don't form part of an offer or contract. No Winkworth employee has authority to make or give any representation or warranty in relation to this property. All fixtures and fittings, whether fitted or not are deemed removable by the vendor unless stated otherwise and room sizes are measured between internal wall surfaces, including furnishings.