



RAWSTORNE STREET, LONDON, EC1V
£1,600,000 FREEHOLD

**A RARE OPPORTUNITY TO ACQUIRE A LATE GEORGIAN GRADE II
TERRACE FREEHOLD TOWN HOUSE ON A QUIET AND PICTURESQUE
STREET IN CLERKENWELL.**

Clerkenwell & City | 020 7405 1288 | clerkenwell@winkworth.co.uk

Winkworth

for every step...

winkworth.co.uk



DESCRIPTION:

The house comprises of a separate lounge and office area, a very attractive open plan kitchen dining room, leading onto a large private garden at the rear. The first floor consists of the beautifully decorated master bedroom with en-suite and overlooks the quiet Georgian street, it retains a large amount of its unique, period charm with the original fireplace. To the rear is a family bathroom and French windows that open on to a large terrace overlooking the garden. The second floor consists of a generous double bedroom with built in storage, a further small bedroom and another bathroom. Rawstorne Street is within easy access of the City and ideally located for the amenities of Upper Street and the trendy restaurants and bars Clerkenwell has to offer.



Winkworth

for every step...



Winkworth

for every step...

Rawstone Street, EC1V

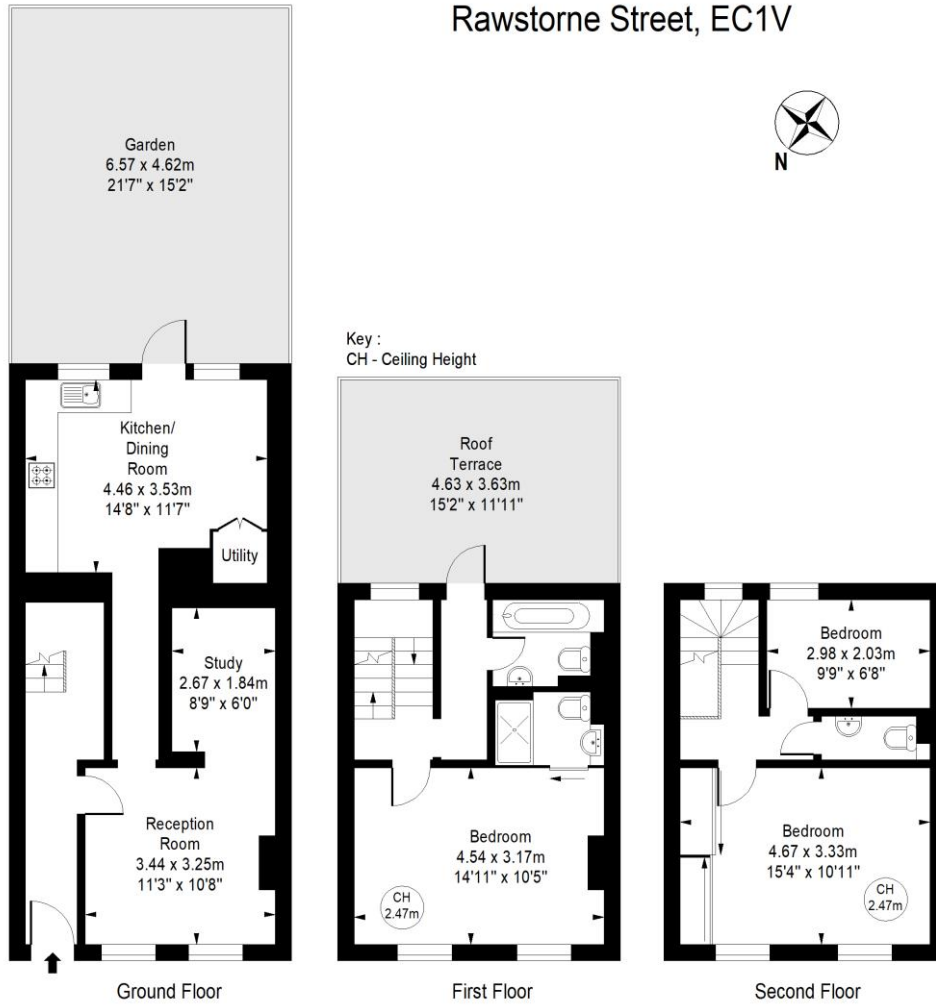

Approx Gross Internal Area 1137 Sq Ft - 105.63 Sq M

Not to scale, for guidance only and must not be relied upon as a statement of fact.
All measurements and areas are approximate only

This floorplan is for illustration purposes only and is not to scale. The position and size of doors, windows, appliances and other features are approximate.

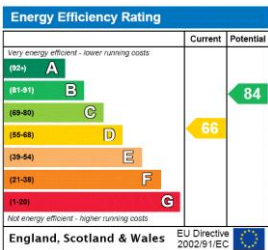

Tenure: Freehold

Council Tax Band: G

Where no figures are shown, we have been unable to ascertain the information. All figures that are shown were correct at the time of printing.

Clerkenwell & City | 020 7405 1288 | clerkenwell@winkworth.co.uk



for every step...

winkworth.co.uk

Winkworth wishes to inform prospective buyers and tenants that these particulars are a guide and act as information only. All our details are given in good faith and believed to be correct at the time of printing but they don't form part of an offer or contract. No Winkworth employee has authority to make or give any representation or warranty in relation to this property. All fixtures and fittings, whether fitted or not are deemed removable by the vendor unless stated otherwise and room sizes are measured between internal wall surfaces, including furnishings.