



## 43 DUNN CRESCENT

KINTBURY RG17 9UH

**A fantastic 2 bedroom terraced house located in the popular village of Kintbury.**

As you enter this property you are greeted by bright and airy entrance hall, a versatile double aspect living/dining room, modern kitchen, conservatory leading out to the rear garden and generous sized study that has been converted from the original garage.

As you walk upstairs you see that the property has two well-proportioned bedrooms and a modern re-fitted family bathroom.

There is a lovely rear garden that is made up of patio, lawn flanked by flower beds and a shed.

To the front of the property there is a driveway and front lawn.



**Winkworth**

## AT A GLANCE

800 Square feet/74 square metres  
Two bedrooms  
Bathroom  
Sitting room  
Study  
Kitchen  
Garden  
Parking

## UTILITIES

West Berkshire Council Tax Band C  
EPC E  
Mains electricity  
Mains water and drainage  
Superfast Broadband is available in the area and there are no known mobile coverage issue.

## SITUATION

Close to the centre of Kintbury. The village centre features a shop and is just a few minutes from Kintbury's mainline railway station and The Dundas Arms, a lovely riverside pub. You can be in London in an hour.

## DIRECTIONS

What3words///goggles.stubbed.tomato



Approximate Floor Area = 74.3 sq m / 800 sq ft

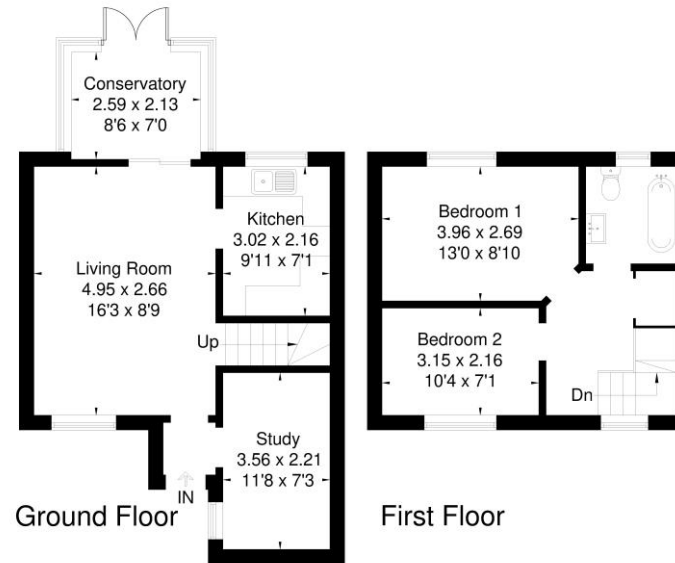

Drawn for illustration and identification purposes only by @fourwalls-group.com #71319



## Newbury Office

43 Northbrook Street, Newbury, Berkshire RG14 1DT  
01635 552552 | [newbury@winkworth.co.uk](mailto:newbury@winkworth.co.uk)

[winkworth.co.uk/newbury](http://winkworth.co.uk/newbury)

# Winkworth

See things differently.