



MANOR WAY, HERTFORDSHIRE, WD6
£535,000 FREEHOLD

A THREE BEDROOM SEMI DETACHED HOUSE IN SOUTH BOREHAMWOOD.

Borehamwood | 020 8953 8899 | borehamwood@winkworth.co.uk



DESCRIPTION:

Positioned a short walk from several sought after and "Good" Ofsted rated schools including Yavneh and Summerswood is this chain free three bedroom semi detached family house.

With a generous Westerly facing garden to the rear and a garage approached via its own driveway the property offers substantial scope for extensions, subject to the usual planning consents.

Bus routes including the 292 and 107 are nearby and amongst other locations, provide access to Elstree and Borehamwood Thameslink station, Edgware Northern Line station and New Barnet National Rail Station.

AT A GLANCE

- 3 Bedrooms
- Chain Free
- Garage With Own Drive
- Westerly Facing Rear Garden
- South Borehamwood
- Off Street Parking
- Gas Central Heating
- Double Glazed
- 806 Square Feet





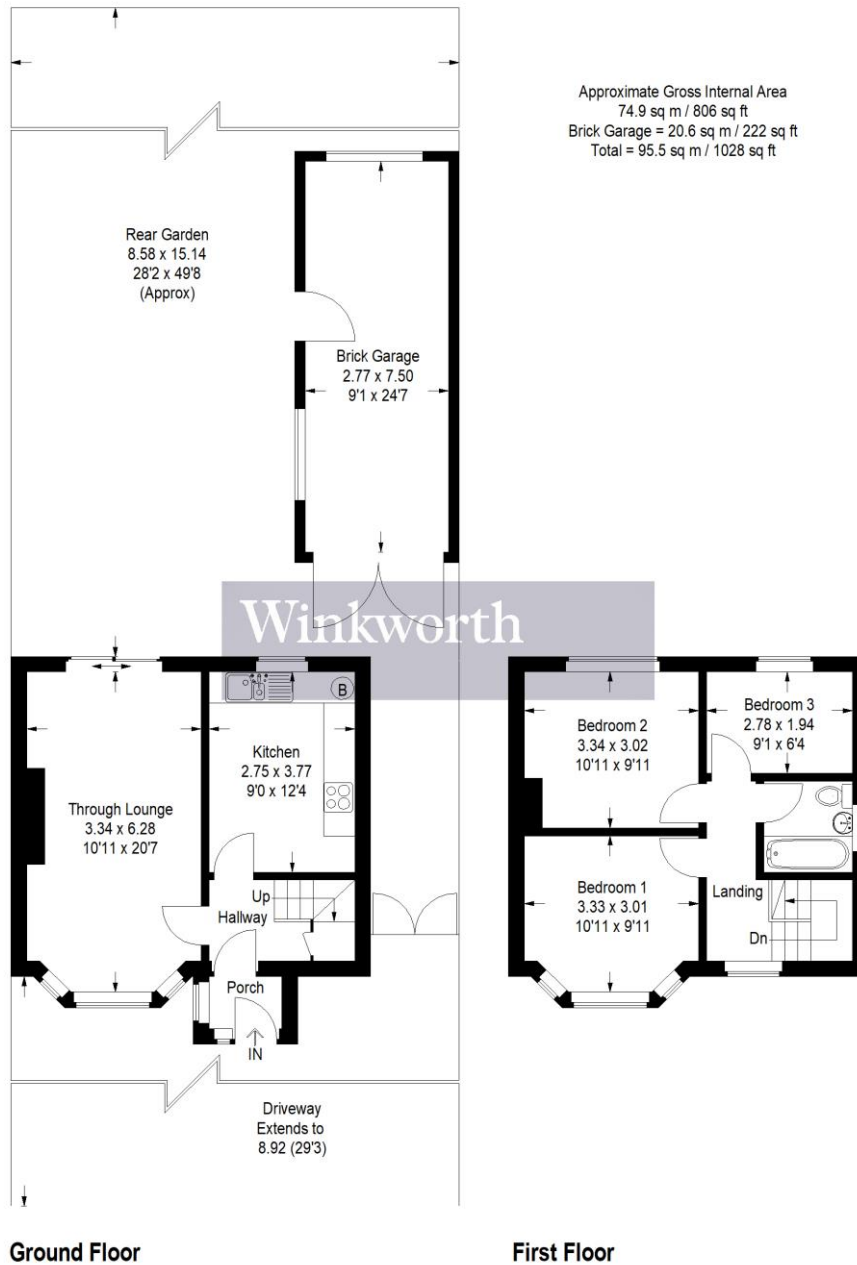

Illustration for identification purposes only, measurements are approximate, not to scale. Winkworth © 2022 (ID856279)

This floorplan is for illustration purposes only and is not to scale. The position and size of doors, windows, appliances and other features are approximate.

