



## ASHLEY COURT, LONDON, SW1P

£425,000

SHARE OF FREEHOLD

### At a glance...

- Studio Flat
- 5th Floor with Lift
- Bright
- Lovely Condition
- Great Presentation
- Council Tax Band: C

**Winkworth**

for every step...



Energy Efficiency Rating		
	Current	Potential
Very energy efficient - lower running costs		
(92+) <b>A</b>		
(81-91) <b>B</b>		
(69-80) <b>C</b>	76	77
(55-68) <b>D</b>		
(39-54) <b>E</b>		
(21-38) <b>F</b>		
(1-20) <b>G</b>		
Not energy efficient - higher running costs		
England, Scotland & Wales	EU Directive 2002/91/EC	

## ASHLEY COURT, LONDON, SW1P

£425,000

SHARE OF FREEHOLD

An incredibly bright studio flat on the 5th floor (with lift) of Ashley Court - a well-maintained mansion building in the heart of Westminster.

The property offers a large studio room with West-facing window and throughout is well presented and in great condition. Featuring a modern kitchen, good size bathroom and great storage the flat requires very little before being able to be used by an incoming purchaser.

Low-maintenance, secure and with a building caretaker this would be an ideal central London pied-a-terre.

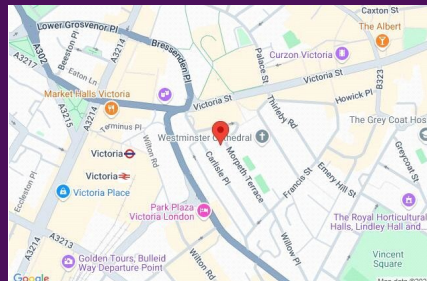

winkworth wishes to inform prospective buyers and tenants that these particulars are a guide and act as information only. All our details are given in good faith and believed to be correct at the time of printing but they don't form part of an offer or contract. No Winkworth employee has authority to make or give any representation or warranty in relation to this property. All fixtures and fittings, whether fitted or not are deemed removable by the vendor unless stated otherwise and room sizes are measured between internal wall surfaces - including fire-chimneys.

### Ashley Court, SW1



Approx. Gross Internal Area  
265 Sq Ft - 24.62 Sq M

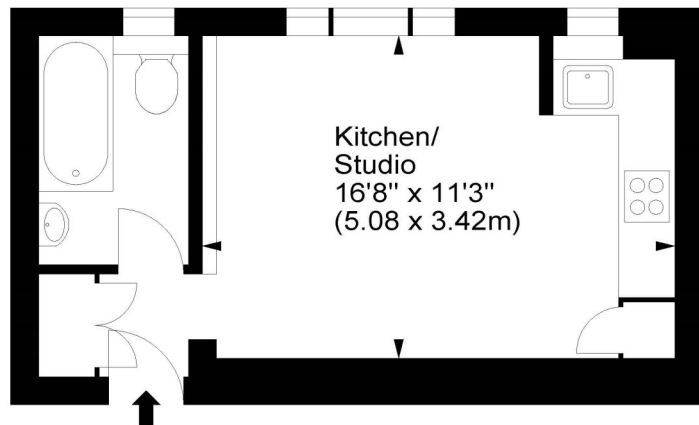

Fifth Floor

For illustration purposes only. Not to scale.  
All measurements are taken and shown at floor level.  
[www.r3photography.co.uk](http://www.r3photography.co.uk) © Photography / Floor Plans / Lease Plans / EPCs



Pimlico & Westminster

020 7828 1786

[pimlico@winkworth.co.uk](mailto:pimlico@winkworth.co.uk)

[winkworth.co.uk/pimlico-westminster](http://winkworth.co.uk/pimlico-westminster)

**Winkworth**

for every step...