



HALLEY GARDENS, LEWISHAM, SE13 5PA
£325,000 LEASEHOLD

A LOVELY TWO DOUBLE BEDROOM APARTMENT FOUND ON THE TOP (SECOND) FLOOR IN THIS POPULAR GATED MODERN DEVELOPMENT THAT SITS ON THE GREENWICH MERIDIAN LINE AND IN BETWEEN BLACKHEATH VILLAGE, MANOR HOUSE GARDENS AND LEWISHAM TOWN CENTRE.

Blackheath | 0208 8520999 | blackheath@winkworth.co.uk

Winkworth

winkworth.co.uk

See things differently



DESCRIPTION:

The accommodation comprises; a bright and airy living room with a separate modern kitchen. There are two double bedrooms and a modern bathroom. There are communal gardens and an allocated off street parking space.

This is a great apartment and, in our opinion, would be perfect for first time buyers and buy to let investors. There is no chain. Your immediate viewing is essential.

Halley Gardens is convenient for commuters with just 0.55 miles to Blackheath station, 0.64 miles from Lewisham Station & DLR and 0.48 miles from Hither Green Station and 0.30 miles. Close proximity are locals shops including M&S Food Court just 300 yards away. The popular open spaces of Manor House Gardens, (0.2miles), Blackheath Common, (0.6miles), and Greenwich Park, (0.9 miles), are all within a short walk. The Ofsted rated "Outstanding" St Margaret's Primary School is extremely close and the house sits in the catchment area for Thomas Tallis secondary school.

AT A GLANCE

- gated development
- two double bedrooms
- second (top) floor
- separate kitchen
- allocated off street parking
- communal gardens
- close to stations
- close to shops
- chain free





Second Floor

Approx. 51.3 sq. metres (552.1 sq. feet)

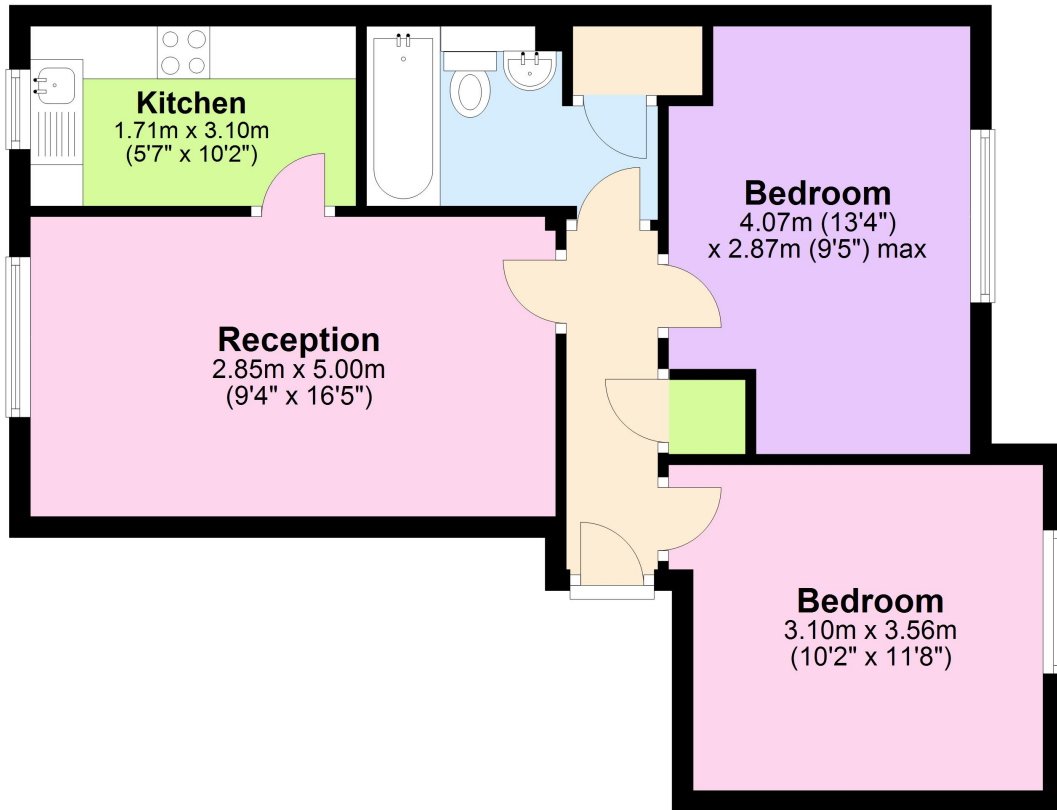

Total area: approx. 51.3 sq. metres (552.1 sq. feet)

This floorplan is for illustration purposes only and is not to scale. The position and size of doors, windows, appliances and other features are approximate. Any lease and service charge details have been provided by the vendor. Any interest party should have these checked by a solicitor as part of the purchase process.

Winkworth