



**THE CAMPIONS, HERTFORDSHIRE, WD6**  
**£1,900 PER MONTH UNFURNISHED**

**A THREE BEDROOM TERRACE HOUSE  
SITUATED IN A SOUGHT-AFTER LOCATION.**

**Borehamwood | 020 8953 8899 | [borehamwood@winkworth.co.uk](mailto:borehamwood@winkworth.co.uk)**





**DESCRIPTION:**



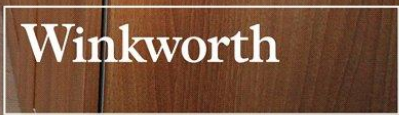



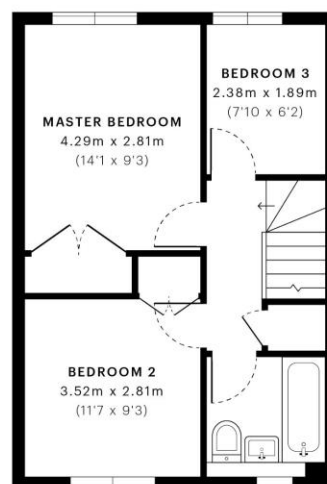
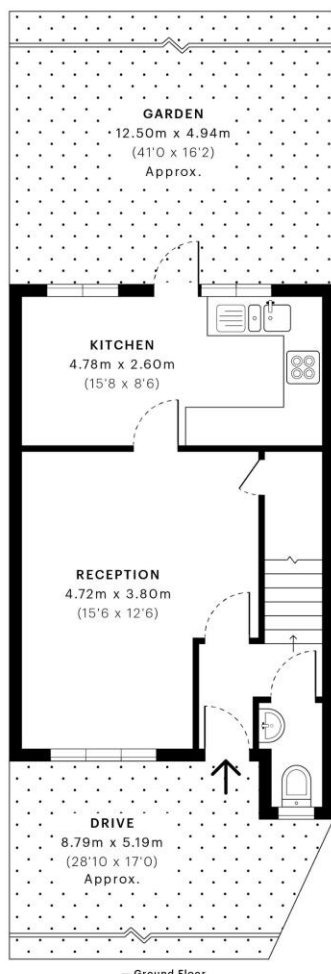

GROSS INTERNAL AREA (GIA)  
The footprint of the property.  
69.8 Sqm / 751.6 Sqft

NET INTERNAL AREA (NIA)  
Excludes walls and external features.  
Includes walkways, restricted head.  
65.1 Sqm / 700.6 Sqft

EXTERNAL STRUCTURAL FEATURES  
Balconies, terraces, verandas etc.  
0.0 Sqm / 0.0 Sqft

RESTRICTED HEAD HEIGHT  
Limited use area under 1.5m  
0.0 Sqm / 0.0 Sqft



Spec floor plans are produced in accordance with the Royal Institution of Chartered Surveyors' Property Measurement Standards. Plots and gardens are illustrative only and are excluded from all area calculations. Due to rounding, numbers may not add up precisely. All measurements shown for the individual room lengths and widths are the maximum points of measurements captured in the scan.



IPMS 3B RESIDENTIAL  
68.7 Sqm / 739.5 Sqft

IPMS 3C RESIDENTIAL  
65.9 Sqm / 708.9 Sqft

SPEC ID  
Sebe4a1793ed780a25bab1f7

This floorplan is for illustration purposes only and is not to scale. The position and size of doors, windows, appliances and other features are approximate.

**Deposit: £2,192.31**

**Holding Deposit:**

**Council Tax Band: D**

Where no figures are shown, we have been unable to ascertain the information. All figures that are shown were correct at the time of printing.

