



MILDMAY GROVE NORTH, LONDON, N1
£875,000 LEASEHOLD

A WONDERFUL THREE BEDROOM FLAT MOMENT FROM NEWINGTON GREEN

Stoke Newington | | stokenewington@winkworth.co.uk

Winkworth

winkworth.co.uk

See things differently



DESCRIPTION:

This charming three-bedroom flat is located in a historic former vicarage in Islington, N1. Set across the first floor, the property offers well-proportioned rooms and benefits from an abundance of storage. Accommodation includes a generous master bedroom with en suite bathroom, a good-sized double bedroom and a smaller third bedroom that could also make the perfect office. The living room benefits from original wooden floors and is flooded with natural light. The kitchen is located to the rear of the flat, which leads out to a fantastic, private terrace. The property is completed with a family bathroom and is offered to the market chain free.

Mildmay Grove North enjoys an ideal location near local shops, cafes, and restaurants on Newington Green, known for its village-like atmosphere. Upper Street, just a short distance away, offers a variety of boutique shops, bars, theatres, and a lively nightlife. Clissold Park provides nearby green space, while transport options across London are excellent, with overground connections at Dalston Kingsland and Dalston Junction, easy access to the City and East London from Essex Road, and Highbury and Islington station (Victoria line) as the nearest tube stop. Numerous bus routes are also available, facilitating convenient travel across London, with international connections from St Pancras.

Any associated charges including, but not limited to, service charge, ground rent and sinking funds outlined in the marketing material is an approximation calculated using information provided by and described by the client at the time of instruction. The actual cost may be subject to change and therefore we recommend all interested parties carry out their own enquiries.

Winkworth



Winkworth

Mildmay Grove North, N1

Approx. Gross Internal Floor Area 807 sq. ft / 75.01 sq. m

Key :
CH - Ceiling Height

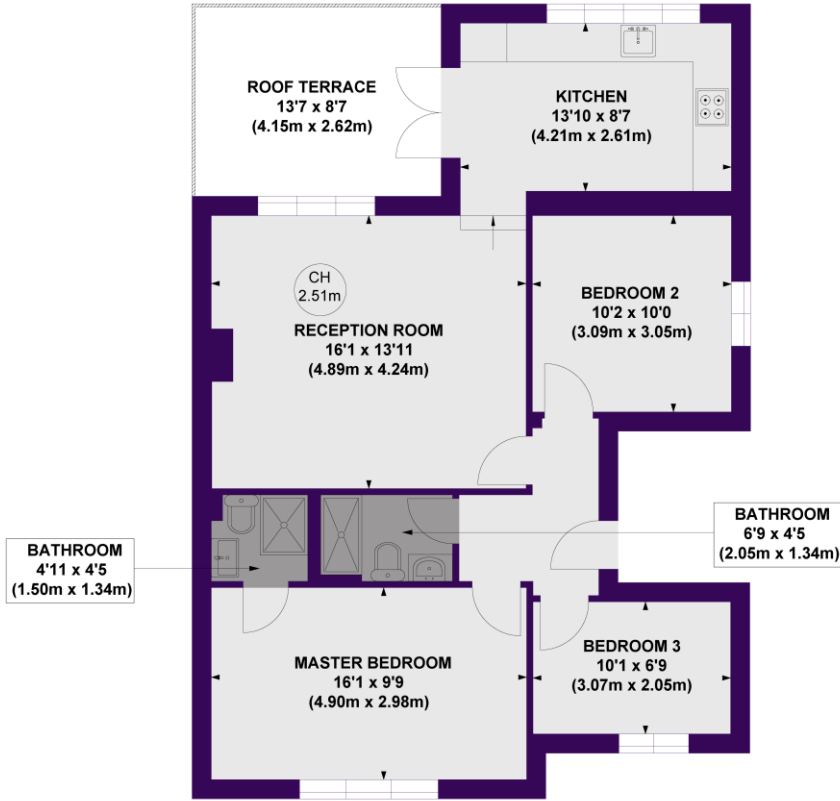

**FIRST FLOOR
GROSS INTERNAL
FLOOR AREA 807 SQ FT**

Winkworth

This floorplan is for illustration purposes only and is not to scale. The position and size of doors, windows, appliances and other features are approximate.

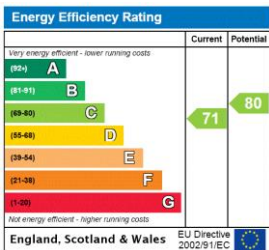

Stoke Newington | | stokenewington@winkworth.co.uk

Winkworth

winkworth.co.uk

See things differently

Winkworth wishes to inform prospective buyers and tenants that these particulars are a guide and act as information only. All our details are given in good faith and believed to be correct at the time of printing but they don't form part of an offer or contract. No Winkworth employee has authority to make or give any representation or warranty in relation to this property. All fixtures and fittings, whether fitted or not are deemed removable by the vendor unless stated otherwise and room sizes are measured between internal wall surfaces, including furnishings.