



**DALRYMPLE CLOSE, N14**  
**£279,995 LEASEHOLD**

**A WELL-PRESENTED ONE-BEDROOM GROUND FLOOR  
FLAT IN A SOUGHT-AFTER LOCATION IN SOUTHGATE.**

Palmers Green | 020 8920 9900 | [palmersgreen@winkworth.co.uk](mailto:palmersgreen@winkworth.co.uk)

**Winkworth**

for every step...

[winkworth.co.uk](http://winkworth.co.uk)



## DESCRIPTION:

A lovely one-bedroom apartment set on the ground floor of a purpose-built development, located in a quiet residential cul-de-sac, within easy reach of Southgate Tube Station (approximately 0.6 miles), Oakwood Park, and several popular schools.

The property features a spacious living room with an opening at one end leading to the kitchen. There is also a double bedroom with a fitted wardrobe and a contemporary-style bathroom with a three-piece suite. Additional benefits include double glazing throughout, with the living room and bedroom windows overlooking the communal grounds, an intercom entry system, electric storage heating, and an allocated residents' parking space. This property is ideal for first-time buyers or investors. Offered with a long lease and peppercorn ground rent.

**Tenure:** Leasehold

**Term:** Approx. 157 years remaining (189 years from 1 September 1993)

**Service Charge:** £2,378 per annum (includes buildings insurance and water rates)

**Ground Rent:** Peppercorn

**Council Tax:** London Borough of Enfield – Band C

All figures that are shown were correct at the time of listing.



**Dalrymple Close, N14**  
 Approx. Gross Internal Floor Area 426 sq. ft / 39.61 sq. m

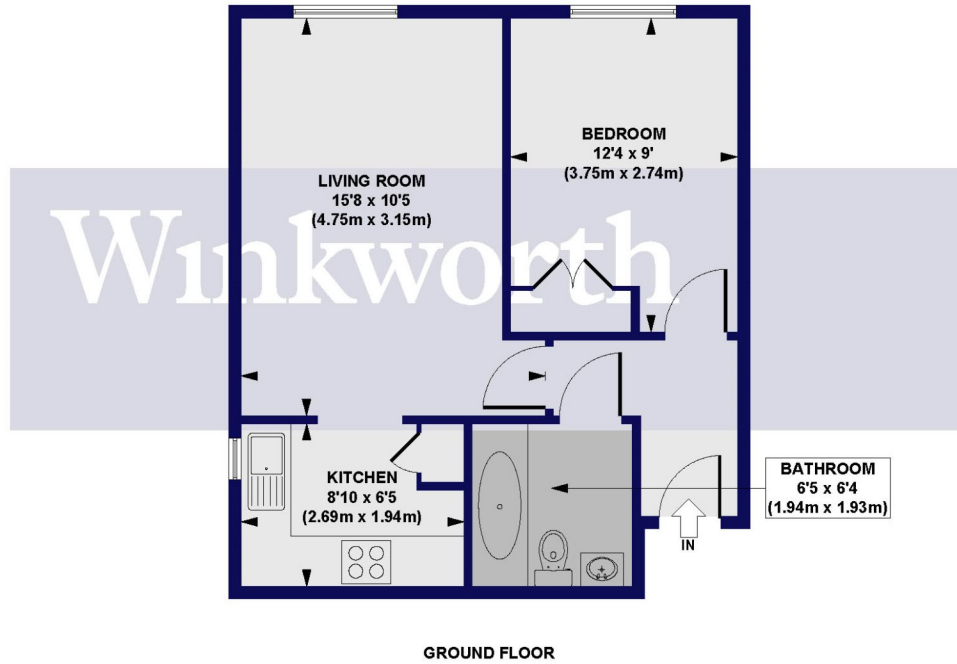

All measurements of walls, doors, windows, fittings and appliances, including their size and location, are shown as standard sizes and do not constitute any warranty or representation by the seller, their agent or CP Creative. Any intending purchaser must satisfy himself by inspection or otherwise as to the correctness of the information contained in these plans.

This floorplan is for illustration purposes only and is not to scale. The position and size of doors, windows, appliances and other features are approximate.

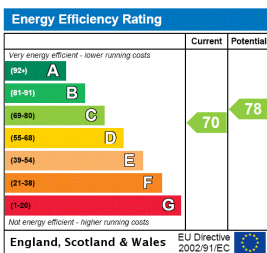

Palmer's Green | 020 8920 9900 | palmer'sgreen@winkworth.co.uk



for every step...

winkworth.co.uk

Winkworth wishes to inform prospective buyers and tenants that these particulars are a guide and act as information only. All our details are given in good faith and believed to be correct at the time of printing but they don't form part of an offer or contract. No Winkworth employee has authority to make or give any representation or warranty in relation to this property. All fixtures and fittings, whether fitted or not are deemed removable by the vendor unless stated otherwise and room sizes are measured between internal wall surfaces, including furnishings.