



OAKLEY HOUSE, LONDON, SW1X
£325,000 LEASEHOLD

DESCRIPTION:

A SHORT LEASE flat in a sought-after building on Sloane Street, situated on the fourth floor with a wonderful view overlooking the landscaped gardens of Cadogan Place, to which the flat enjoys access (subject to an annual subscription).

The vendor qualifies to petition for a statutory lease extension, which can be initiated as part of the conveyance if required. Please contact the office to discuss potential costs and the process in more detail.

Knightsbridge & Chelsea | 0207 589 6616 | knightsbridge@winkworth.co.uk

Winkworth

for every step...

Oakley House,
Sloane Street, SW1X
Approximate Gross Internal Area
47.72 sq m / 514 sq ft
(CH = Ceiling Heights)

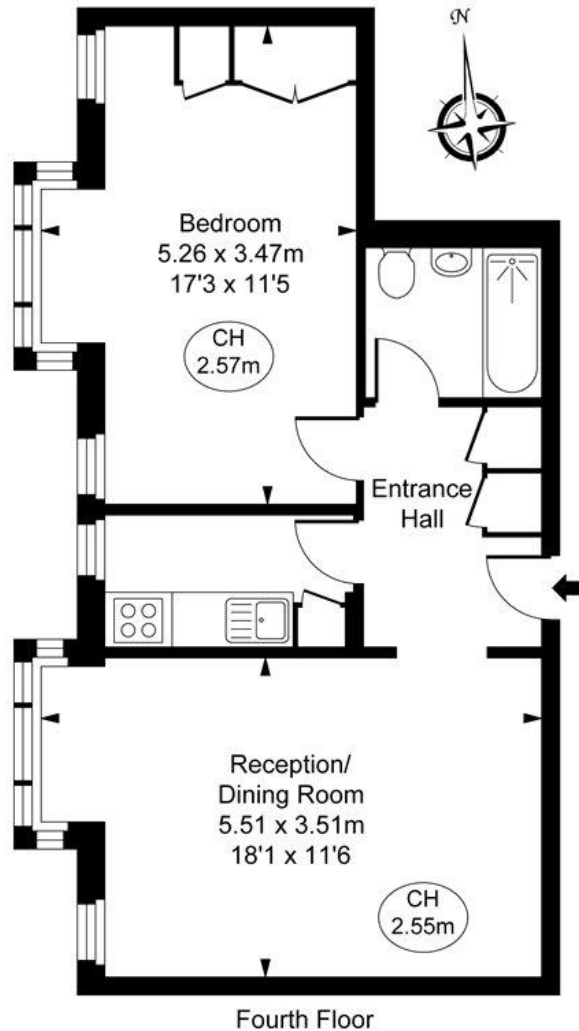

This plan is not to scale. It is for guidance and not for valuation purposes.
All measurements and areas are approximate only, and have been prepared in accordance with the current edition of the RICS Code of Measuring Practice.
© Fulham Performance

This floorplan is for illustration purposes only and is not to scale. The position and size of doors, windows, appliances and other features are approximate.
For more details visit: <https://www.winkworth.co.uk/sale/property/KBR100609>

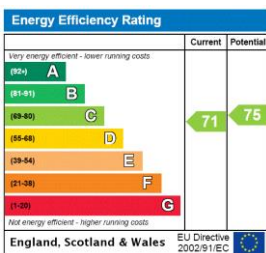

Tenure: Leasehold
Term: Expires - 25/12/2033
Lease length: 9 Year – 6 months
Service Charge: £5,280 per annum plus reserve fund of £1,500
Ground Rent: £75 Annually (subject to increase)
Council Tax Band:
 Where no figures are shown, we have been unable to ascertain the

Knightsbridge & Chelsea | 0207 589 6616 | knightsbridge@winkworth.co.uk



for every step...

winkworth.co.uk

Winkworth wishes to inform prospective buyers and tenants that these particulars are a guide and act as information only. All our details are given in good faith and believed to be correct at the time of printing but they don't form part of an offer or contract. No Winkworth employee has authority to make or give any representation or warranty in relation to this property. All fixtures and fittings, whether fitted or not are deemed removable by the vendor unless stated otherwise and room sizes are measured between internal wall surfaces, including furnishings.