



UPPER TOOTING ROAD, SW17
£400,000 LEASEHOLD

A FANTASTIC FIRST FLOOR TWO BEDROOM, TWO BATHROOM APARTMENT.

Tooting | 020 8767 5221 | tooting@winkworth.co.uk

Winkworth

for every step...

winkworth.co.uk



DESCRIPTION:

A fantastic first floor two bedroom, two bathroom apartment.

Situated in a secure gated development the apartment offers stylish, contemporary accommodation in a highly desirable location in Tooting Bec. The flat boasts two good sized double bedrooms, with the master bedroom having its own en-suite shower room and access to the private balcony. A further spacious bathroom is located to the front of the flat and a generous semi open plan kitchen/living area is located to the rear, again with its own separate access to the balcony.

The property is located within 0.2 miles from Tooting Bec underground station and close to a great selection of shops and amenities. The open spaces of Tooting Bec Common are also easily accessed. While Tooting Bec Underground Station (Northern Line) is nearby for easy access to central London.

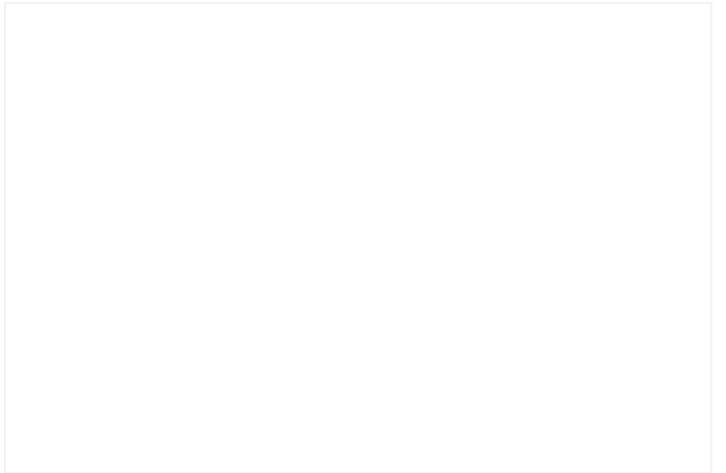
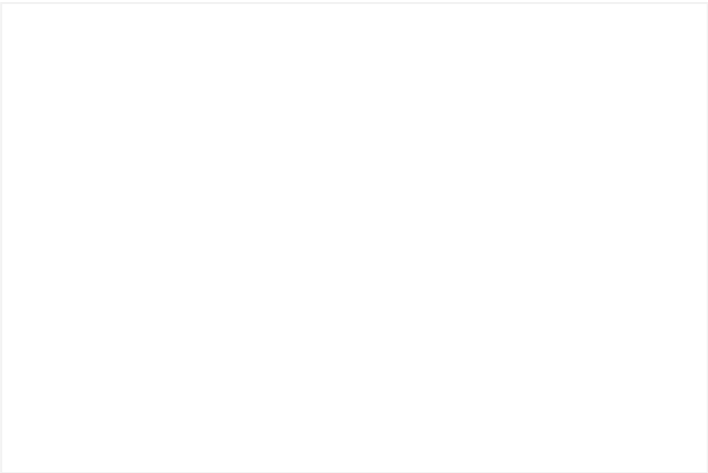

Whitham Court, SW17

Approx. Gross Internal Floor Area 610 sq. ft / 56.68 sq. m

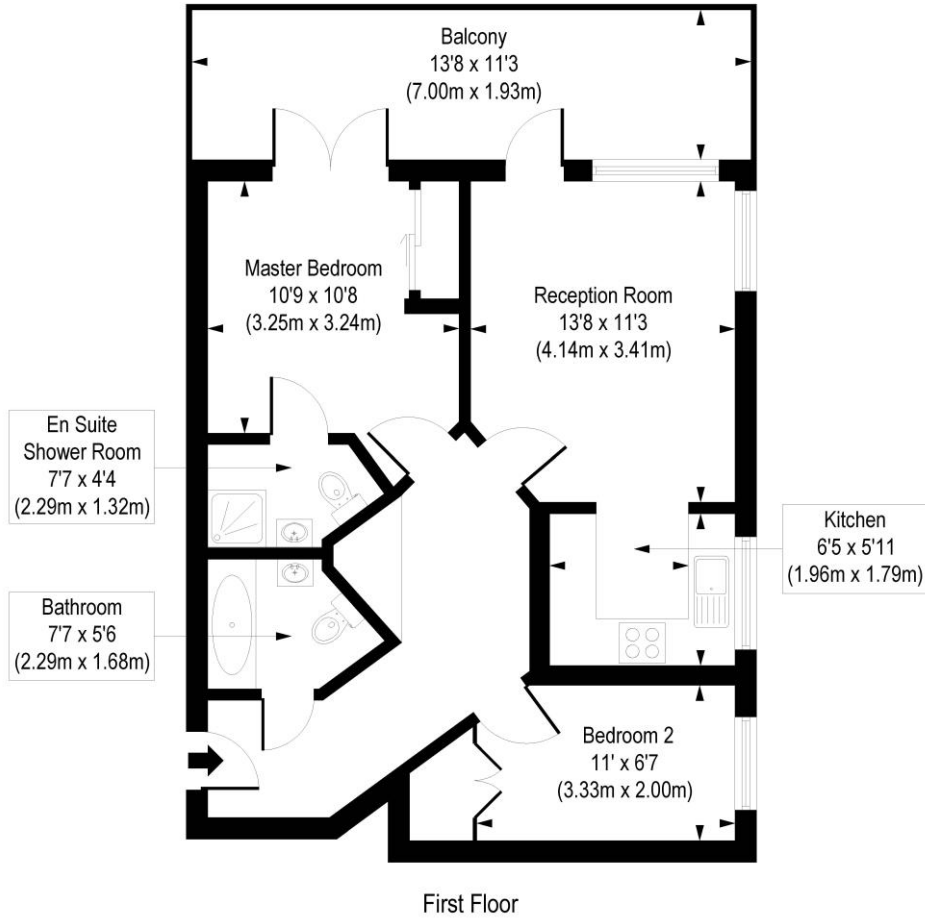
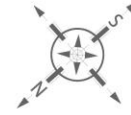

COMPLIANT WITH RICS CODE OF MEASURING PRACTICE. Floorplan is for illustrative purposes only and is not to scale. Every attempt has been made to ensure the accuracy of the floorplan shown, however all measurements, fixtures, fittings and data shown are an approximate interpretation for illustrative purposes only. Liability for errors, omissions or mis-statement through negligence or otherwise is hereby excluded.

This floorplan is for illustration purposes only and is not to scale. The position and size of doors, windows, appliances and other features are approximate.

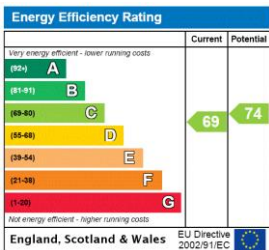

Tooting | 020 8767 5221 | tooting@winkworth.co.uk

for every step...

winkworth.co.uk

Winkworth wishes to inform prospective buyers and tenants that these particulars are a guide and act as information only. All our details are given in good faith and believed to be correct at the time of printing but they don't form part of an offer or contract. No Winkworth employee has authority to make or give any representation or warranty in relation to this property. All fixtures and fittings, whether fitted or not are deemed removable by the vendor unless stated otherwise and room sizes are measured between internal wall surfaces, including furnishings.