



**STEDHAM CHAMBERS, COPTIC STREET, LONDON, WC1A**  
**£699,950 LEASEHOLD**

A LOVELY ONE-BEDROOM FLAT ON THE FIRST FLOOR OF THIS VICTORIAN BLOCK IN THE HEART OF BLOOMSBURY WITH A COMMUNAL GARDEN 80 YARDS TO THE BRITISH MUSEUM. THERE IS A LIFT.

Leasehold: Approx. 185 years remaining | Service Charge: Approx. £1,425.06 | Ground Rent: NIL | Council Tax Band: Camden D, Payable 2011

West End | 020 7240 3322 | westend@winkworth.co.uk

**Winkworth**

for every step...

[winkworth.co.uk](http://winkworth.co.uk)





### DESCRIPTION:

The property is very well kept and is very attractive having good light. Stedham chambers is a well-managed gated block with attractive communal gardens. The property is close to Tottenham court road tube and the Elizabeth line, Covent garden and Soho. The universities of LSE Kings and UCL are all close by. This is an excellent central location.



**Winkworth**

for every step...





**Winkworth**

for every step...

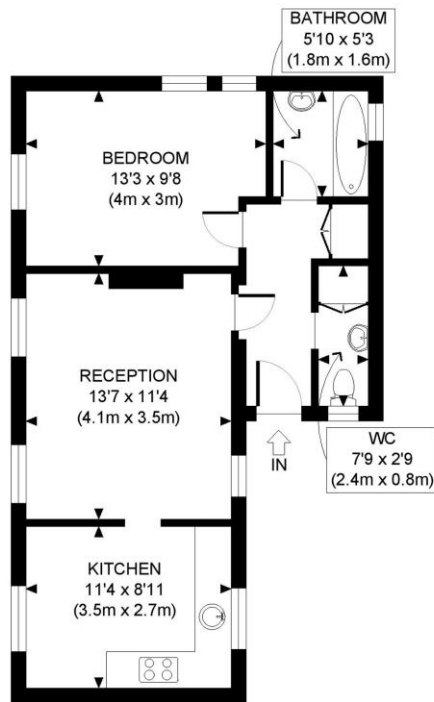

FIRST FLOOR  
GROSS INTERNAL  
FLOOR AREA 506 SQ FT



APPROX. GROSS INTERNAL FLOOR AREA: 506 SQ FT/ 47 SQM

**Winkworth**

This plan is for illustrative purposes only and should be used as such by any prospective client. Whilst every attempt has been made to ensure the accuracy of the Floor Plan contained here, measurements of the doors, windows, rooms and any other items are approximate and no responsibility is taken for any errors, omissions, or misstatement. The services, systems and appliances shown have not been tested and no guarantee as to the operability or efficiency can be given.

**PROPERTY PHOTO PLANS**  
THE FIRST STEP FOR PROPERTY PHOTOGRAPHERS

This floorplan is for illustration purposes only and is not to scale. The position and size of doors, windows, appliances and other features are approximate.

**Tenure:** Leasehold

**Term:** 184 year and 7 months

**Service Charge:** Approx. £1,425.06 per annum

**Ground Rent:** NIL

**Council Tax Band:** D, payable 2011

Where no figures are shown, we have been unable to ascertain the information. All figures that are shown were correct at the time of printing.

West End | 020 7240 3322 | westend@winkworth.co.uk

**Winkworth**

for every step...

winkworth.co.uk

Winkworth wishes to inform prospective buyers and tenants that these particulars are a guide and act as information only. All our details are given in good faith and believed to be correct at the time of printing but they don't form part of an offer or contract. No Winkworth employee has authority to make or give any representation or warranty in relation to this property. All fixtures and fittings, whether fitted or not are deemed removable by the vendor unless stated otherwise and room sizes are measured between internal wall surfaces, including furnishings.