



LOWER CLAPTON ROAD, LONDON, E5
£330,000 LEASEHOLD

DELIGHTFUL ONE BEDROOM FLAT IN THE HEART OF LOWER CLAPTON.

Hackney | 020 8986 4216 | hackney@winkworth.co.uk

Winkworth

winkworth.co.uk

See things differently



DESCRIPTION:

A beautifully refurbished second-floor flat in the heart of Lower Clapton. The property comprises of a bright reception room, a contemporary kitchen with plenty of space for dining, generous double bedroom with enough room for built in or stand-alone furniture and a recently modernised shower room. Furthermore, the property has been recently enhanced in the following areas:

- New flooring
- Newly fitted double glazing to ensure effective heat insulation
- A new roof including a guarantee for long-term peace of mind
- Newly decorated communal hallway and entrance

Located on Lower Clapton Road, in the vibrant hub of Lower Clapton, with Chatsworth Road a short walk away you can enjoy the fantastic market offering artisan and seasonal produce, along with an excellent mix of restaurants and independent shops.

Stunning parks are in abundance, all within walking distance, including Millfields Park, Hackney Downs, Victoria Park and London Fields. There are excellent transport links via an excellent bus network, plus overground services from Hackney Central, Hackney Downs and Homerton, offering easy connections to the City, London's West End and beyond.

Winkworth



Winkworth

Lower Clapton Road, E5
Approx. Gross Internal Floor Area 351 sq. ft / 32.6 sq. m

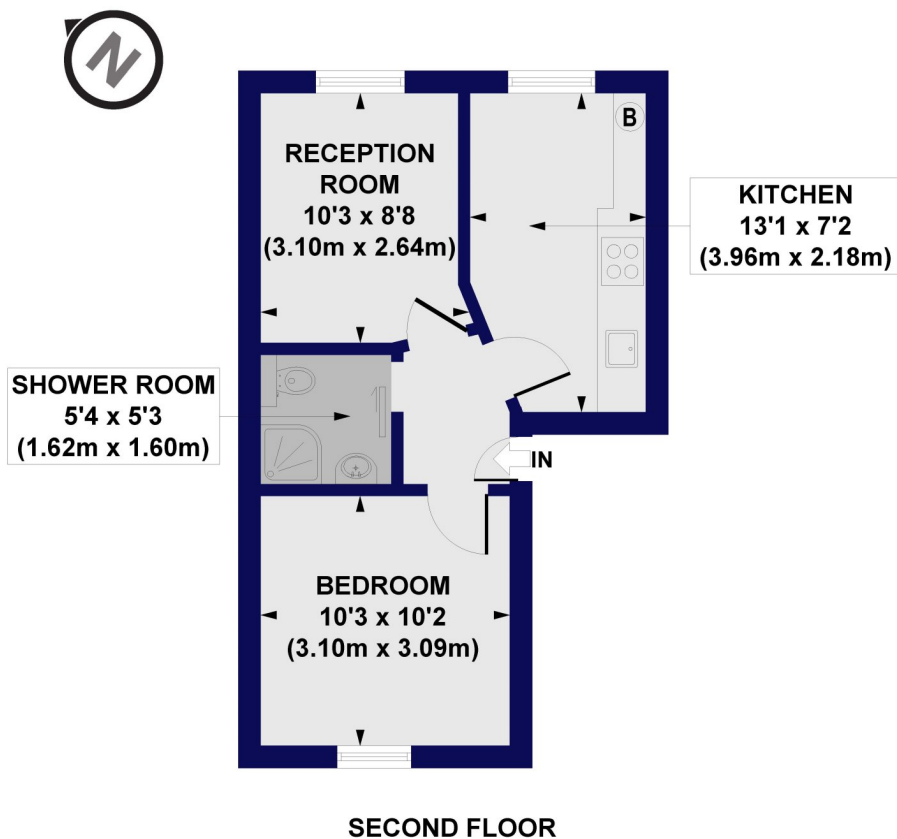

All measurements of walls, doors, windows, fittings and appliances, including their size and location, are shown as standard sizes and do not constitute any warranty or representation by the seller, their agent or CP Creative. Any intending purchaser must satisfy himself by inspection or otherwise as to the correctness of the information contained in these plans. This plan is for illustrative purposes only and should be used as such by any prospective purchasers.

Winkworth

This floorplan is for illustration purposes only and is not to scale. The position and size of doors, windows, appliances and other features are approximate.

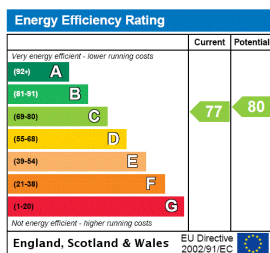

Hackney | 020 8986 4216 | hackney@winkworth.co.uk

Winkworth

winkworth.co.uk

See things differently

Winkworth wishes to inform prospective buyers and tenants that these particulars are a guide and act as information only. All our details are given in good faith and believed to be correct at the time of printing but they don't form part of an offer or contract. No Winkworth employee has authority to make or give any representation or warranty in relation to this property. All fixtures and fittings, whether fitted or not are deemed removable by the vendor unless stated otherwise and room sizes are measured between internal wall surfaces, including furnishings.