



BATHURST GARDENS, NW10
£2,250 PER MONTH UNFURNISHED

SUPERBLY FINISHED GROUND FLOOR TWO BEDROOM APARTMENT WITH CORCORIS LANDSCAPED GARDEN

Kensal Rise & Queens Park | 0208 960 4947 |
kensalrise@winkworth.co.uk

Winkworth

for every step...

winkworth.co.uk



DESCRIPTION:

Winkworth are delighted to offer back to the lettings market this beautiful ground floor garden flat. Comprises two spacious double bedrooms, large bay fronted reception with window shutters, modern kitchen and high spec shower room. The property has been tastefully decorated to the highest of standards and benefits with stunning hard wood flooring throughout. To the rear a south facing landscaped garden with patio area and access from both the rear bedroom and kitchen.

Council tax - (Band D)

Ward - Kensal Green

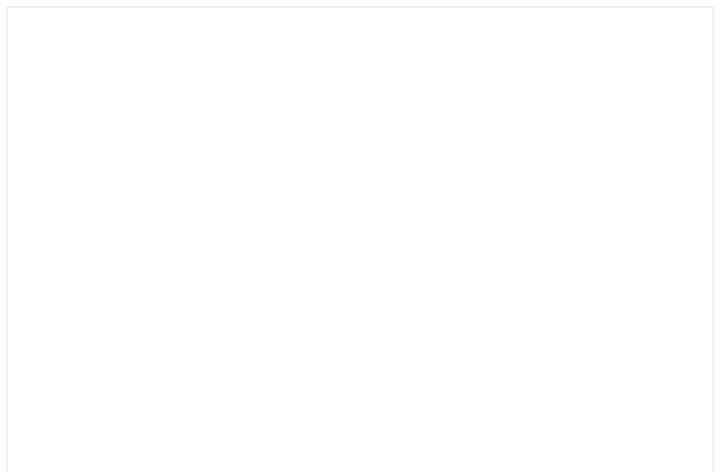
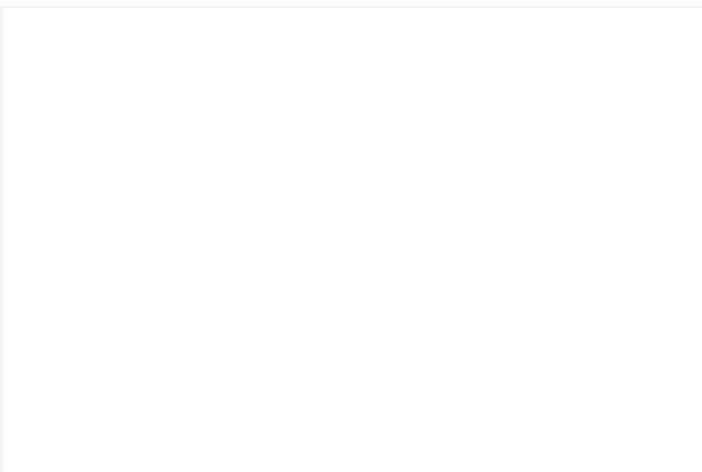

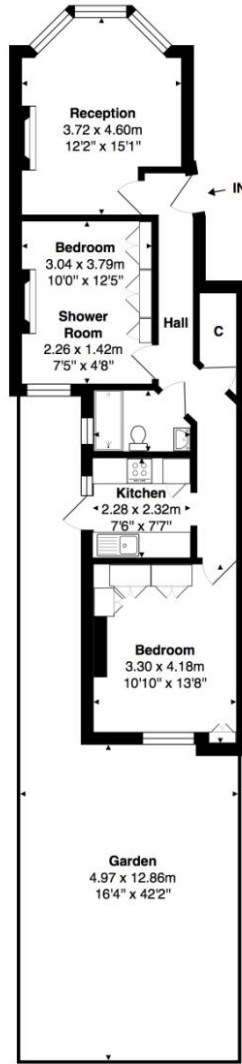

Ground Floor

Total Area: 61.5 m² ... 662 ft² (excluding garden)

All measurements are approximate and for display purposes only

This floorplan is for illustration purposes only and is not to scale. The position and size of doors, windows, appliances and other features are approximate.

Deposit: 5 weeks rent

Holding Deposit: 1 weeks rent

Council Tax Band: D

Where no figures are shown, we have been unable to ascertain the information. All figures that are shown were correct at the time of printing.

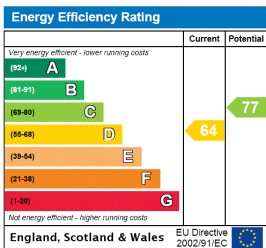

Kensal Rise & Queens Park | 0208 960 4947 | kensalrise@winkworth.co.uk



for every step...

winkworth.co.uk

Winkworth wishes to inform prospective buyers and tenants that these particulars are a guide and act as information only. All our details are given in good faith and believed to be correct at the time of printing but they don't form part of an offer or contract. No Winkworth employee has authority to make or give any representation or warranty in relation to this property. All fixtures and fittings, whether fitted or not are deemed removable by the vendor unless stated otherwise and room sizes are measured between internal wall surfaces, including furnishings.